

MATRIX CABINETS

Fine Kitchen & Bath Cabinetry



Forevermark
cabinetry™



2021 DEALER CATALOG

www.matrixcabinets.com



Table of Contents

Section	A	About Matrix Cabinets
Section	B	Pricing Silver Line
Section	C	Pricing K-White
Section	D	Pricing Gold Line
Section	E	Pricing Platinum Line
Section	F	Pricing Titanium Line
Section	G	Pricing Glass Doors
Section	H	Pricing Accessories
Section	I	Specification Sheets
Section	J	Order Forms
Section	K	Warranty



Thank you for choosing Matrix Cabinets and Forevermark Cabinetry. We are very proud of our products and know that you will be a valued member of our family. Forevermark & Matrix Cabinets stand behind our quality products and friendly service. We are looking forward to helping your business grow. Please feel free to contact our office directly for any questions you may have.

Sincerely,

Your Forevermark and Matrix Cabinets Team

Our Commitment to Quality

California Air Resources Board

The California Air Resources Board regulates air quality by ensuring that materials and air emissions meet the most stringent requirements. Forevermark is constantly surpassing all requirements for high quality cabinetry. As such, Forevermark Cabinetry products meet the California Air Resources Board's current standards for certification. CARB labeling indicating compliance is on each box and product. For more information, please feel free to visit www.arb.ca.gov.



Kitchen Cabinet Manufacturers Association

Forevermark is proud to offer assembled cabinets that are KCMA certified. KCMA certified cabinets are recognized in the marketplace as a quality product able to perform after a rigorous battery of tests simulating years of household use. For more information visit www.kcma.org.



National Kitchen & Bath Association

Forevermark is a member at the National Kitchen & Bath Association. Being part of this association keeps us informed with the latest news and developments in the industry. For more information, please feel free to contact our offices or visit www.nkba.org.



GREENGUARD CERTIFIED

Forevermark Cabinetry is proud to further demonstrate our commitment to the well-being of our customers by offering select lines with UL Environment's Greenguard® certification. The GREENGUARD Certification Program (formerly known as GREENGUARD Indoor Air Quality Certification) gives assurance that products designed for use in indoor spaces meet strict chemical emissions limits, which contribute to the creation of healthier interiors.



WATERBORNE UV FINISHES

Forevermark Cabinetry features the use of waterborne UV finishes furnished by Sherwin-Williams on certain door styles.* The benefits of waterborne UV finishes include superior scratch resistance, low VOCs, finishes that are formaldehyde-hazard free, and reduction in environmental impact.

You can be sure that the solutions you're choosing satisfy the highest standards for performance, while meeting or exceeding regulatory requirements. Which means you'll never have to choose between the best coatings for the environment and the best coatings for delivering a quality look that lasts.



FOREST STEWARDSHIP COUNCIL® CERTIFIED

Forevermark Cabinetry is proud to offer select products with raw materials that are Forest Stewardship Council® (FSC) certified through its supplier. The FSC® is an independent, non-profit organization that protects forests for future generations, and is the only system supported by groups such as WWF, Sierra Club, Greenpeace, Natural Resources Defense Council, and National Wildlife Federation. The FSC® protects water quality, prohibits highly hazardous chemicals, restricts deforestation, protects customary rights of indigenous people and local communities, prevents loss of natural forest cover, protects high conservation value forests, and limits clearcuts to protect forest ecology.

By purchasing a FSC-certified product, customers can ensure that their product is coming from responsibly managed sources.



The mark of
responsible forestry

NEW!

Eucalyptus Grandis is a consistent, premium hard-wood material with the following benefits:

- Durability-used often in high-end applications
- Sustainable & Eco-friendly
- High level of dimensional stability
- Exceptionally versatile
- Superior grain consistency



AN



TG

* Applicable to Nova Light Grey Shaker (AN) and Midtown Grey (TG) (raw materials only)



NOW OFFERING ASSEMBLY

Matrix Cabinets offers assembled cabinets to all dealers. The rate for assembly is \$20 per cabinet. Orders are shipped freight class 150 instead of class 70, so freight rates will be quoted per individual order. Lead time on assembled cabinet orders is 8-10 business days on items stocked in Georgia (AB, AG, AP, AW, GW, KC, KE, KM, SL, TW, TQ.). For all other items the lead time would be 12-15 business days.

EXPORT SHIPPING

Export packaging is available for our customers sending shipments overseas. Pricing will be determined by size of order. Please indicate this option in writing on your order form.

ORDERING DETAILS

Orders may be sent in via email on a Matrix Cabinets Order Form or Online by using your Email Address and Password.

SHIPPING

Common Carriers/Ground Shipments: A freight quote will be generated on all invoices. When this occurs, the dealer is responsible for remitting payment prior to shipping.

WARRANTY INFORMATION

There is a five year limited warranty on factory defects for most door styles. All painted door styles have a two year limited warranty. Matrix Cabinets will replace the defective part(s) and ship it to you at our cost using the most appropriate shipping method. More warranty information found at www.matrixcabinets.com.

CLAIMS/RETURNS/REPLACEMENTS

All matters dealing with Claims>Returns\Replacements must go through our Warranty Department. A "Warranty Form" must be filled out Online, emailed to warranty@matrixcabinets.com or faxed to (912) 366-0122.

Freight Claims

- Verify that your order is intact and correct BEFORE signing the driver's delivery slip. Any incorrect or missing items claims will NOT be honored once a delivery is signed for.
- Note on the driver's delivery ticket any items that appear damaged or are missing.

Replacements Claims

- Open all boxes within fourteen (14) days of delivery.
 - If damage is found once cabinets boxes are opened a warranty form must be filled out completely and submitted along with a picture of the damaged item.
 - If a claim is not filed in fourteen (14) days, the item will not be replaced
- Damaged item claims must be made prior to assembly and/or installation.
 - Replacements will not be honored if the item being replaced has been installed or altered.
- We may request that parts/products to be returned upon delivery of any replacement. If this request is not honored within 60 days from delivery of replacement we will charge the dealers account for replacement parts.
- Replacements generally take 3-7 days for processing and shipping. (Varies based on availability.
- Concealed damage on back orders should be claimed within 30 days of last shipment.

Returns

Cabinet Returns can be accepted for return up to 60 days after delivery date. We can only accept RTA returns in new condition and in unopened boxes. Assembled, modified or special order cabinets cannot be returned. Display orders cannot be returned. All returns are subject to inspection and a 25% restocking fee. Returns are accepted for credit only, and applicable credit will be applied to the dealer account. Proper paperwork is required. Items that are confirmed but canceled prior to delivery or refused upon delivery will also incur a restocking fee.

Cabinet Construction

Forevermark Cabinetry is constructed from several pieces of solid wood and wood veneers on plywood. Differences in grain pattern and color should be expected. Color differences in wood are the result of variations in minerals found in the soil native to the tree's origin. Absorption of these minerals will vary by tree or parts of said tree. In addition, color changes can be experienced due to different exposure to light. All species of wood will display characteristics such as knots, pinholes, sap runs, mineral streaks, and darkening with age. It is the natural beauty of wood to exhibit these characteristics and they will be present throughout your cabinetry. Details for individual cabinet construction can be found on our website www.MatrixCabinets.com in the "Our Cabinets" section.

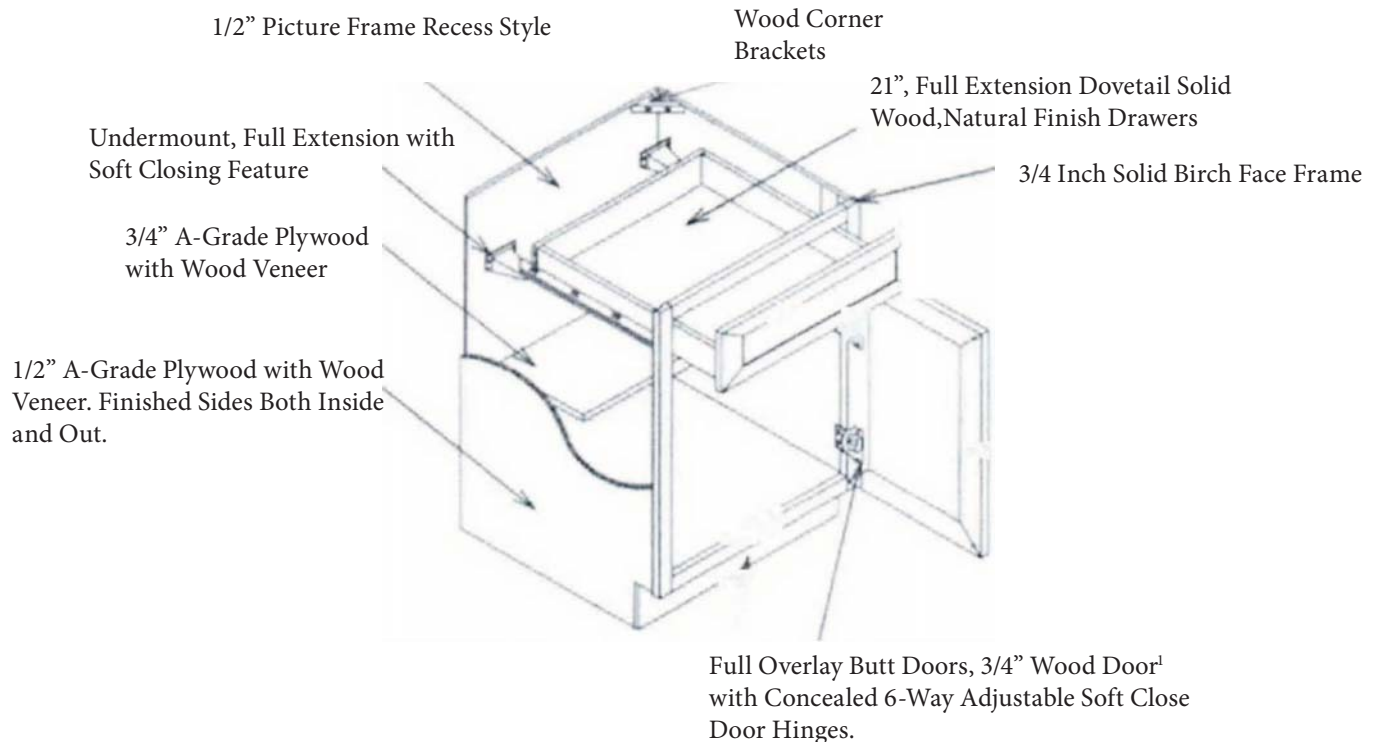

1. a. AB - Lait Grey Shaker: Door is 100% MDF to avoid expansion.
- b. AW - Ice White Shaker: Door is 100% MDF to avoid expansion.
- c. AX - Xterra Blue Shaker: Door is 100% MDF to avoid expansion.
- d. GW - Gramercy White: Center Panel of door is MDF.
- e. SL - Signature Pearl: Center Panel of door is MDF.
- f. TW - Uptown White: Center Panel of door is MDF.
- g. TQ - Townsquare Crema: Center Panel of the door is MDF.
2. All Cabinets are Finished on all Sides. As well as finished bottoms for Wall Cabinets
3. Cabinet Interiors Match the Door Color





Pricing Silver Line

K-Cherry Glaze KC



K-Cinnamon Glaze KM



K-Espresso Glaze KE





K-Cinnamon Glaze



K-Cherry Glaze



K-Espresso Glaze

SILVER LINE FEATURES & BENEFITS

Door Style	K-Cinnamon Glaze (KM), K-Cherry Glaze (KC), K-Espresso Glaze (KE)
Cabinet Style	Full Overlay, Butt Door
Wall & Base	Raised Square (5pc Recessed Drawer Header)
Front Frame	3/4" Solid Birch
Door Frame	3/4" Solid Birch
Door Center	MDF with Birch Veneer
Sides (Wall & Base)	1/2" A-Grade Plywood with Wood Veneer
Bottom (Base)	1/2" A-Grade Plywood with Wood Veneer
Cabinet Interior	Matches Door Color
Back Panel	1/2" Picture Frame Recess Style
Hinges	Concealed 6-Way Adjustable Soft Close Door Hinges
Connectors	Pre-installed, Color Coated Metal Clip, Won't Tarnish
Shelves	3/4" A-Grade Plywood with Wood Veneer
Drawer Box	Solid Wood 5/8" sides
	Drawer Bottom 1/2" Plywood
	Drawer Length 21"
	Dovetail Construction
	Natural Finish
Drawer Glides	Undermount, Full Extension with Soft Closing Feature
Base Corner Supports	Wood Corner Brackets, with Wood I-Beam Construction

Wall Cabinets

24"W -36"W = 2 Butt Doors (2 doors that open towards each other not separated by a center stile.)

Wall Cabinets

30" Wall		36" Wall		42" Wall	
W0930	194	W0936	244	W0942	273
W1230	214	W1236	261	W1242	289
W1530	234	W1536	283	W1542	313
W1830	263	W1836	315	W1842	345
W2130	315	W2136	378	W2142	418
W2430B	337	W2436B	402	W2442B	448
W2730B	368	W2736B	455	W2742B	523
W3030B	380	W3036B	493	W3042B	582
W3330B	408	W3336B	523	W3342B	612
W3630B	436	W3636B	545	W3642B	652

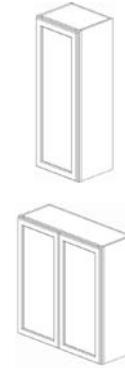

Silver Pricing

Bridge Cabinets

12" Wall		15" Wall		18" Wall		24" Wall	
W3012B	218	W3015B	244	W2418B	234	W2424B	301
W3612B	244	W301524B	331	W3018B	271	W3024B	339
W361224B	335	W3315B	265	W301824B	424	W302424B	400
		W331524B	349	W3318B	289	W3324B	364
		W3615B	271	W331824B	430	W3624B	388
		W361524B	368	W3618B	307	W362424B	450
				W361824B	436		



Wall Diagonal Corner

WDC2430	485
WDC2436	610
WDC2442	644

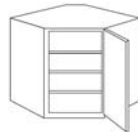

Angle Wall

AW30	333
AW36	400
AW42	467



Microwave Oven

MWO3018PM-12	337
--------------	-----

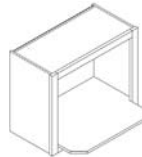

Wall End Shelf

WES530	182
WES536	218
WES542	257

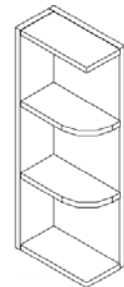

Glass Doors With Mullion

Sizes on page G2



Wine Rack

W3018WR	398
---------	-----

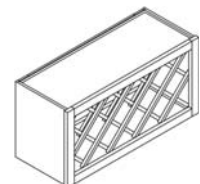

Base Cabinets

24"W -36"W = 2 Butt Doors (2 doors that open towards each other not separated by a center stile.)

Sink Bases

SB24B ¹	455
SB27B	477
SB30B	493
SB33B	511
SB36B	531
SB60B	960

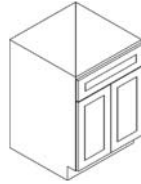

SB24B, SB27B and SB30B

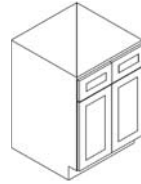

SB33B and SB36B

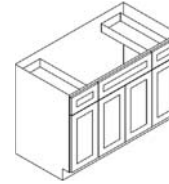

SB60B

1. Not available in KE

Base Diagonal Corner Sink

BDCF36	885
BDCF36K-FL	267

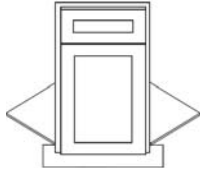

BDCF36KFL Front frame, door and drawer front, floor and toe kick only (not full Cabinet)

Base Cabinets

B09	309
B12	351
B15	368
B18	386
B21	436
B24B	471
B27B	507
B30B	582
B33B	610
B36B	636

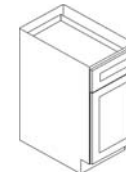

B09-B21

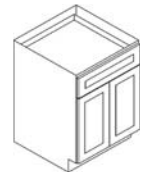

B24B-B30B

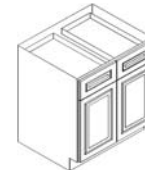

B33B and B36B

Drawer Bases

DB12(3)	600
DB15(3)	626
DB18(3)	642
DB21(3)	661
DB24(3)	699
DB30(3)	1162

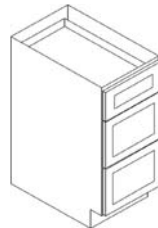

Base Blind Corner Cabinets

BBLC39/42-36"W	665
BBLC42/45-39"W	675
BBLC45/48-42"W	681

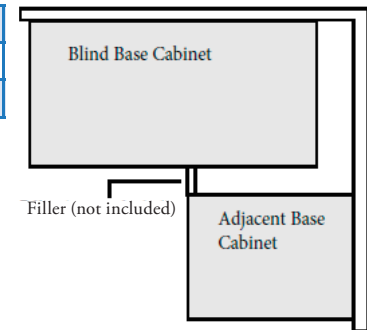
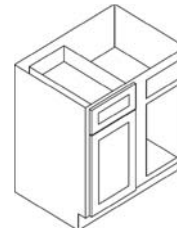

Lazy Susan

LS3309	877
LS3612	945

- LS3309 and LS3612: Bi-Fold Door, 2 independently spinning trays.
- Not soft closing doors.

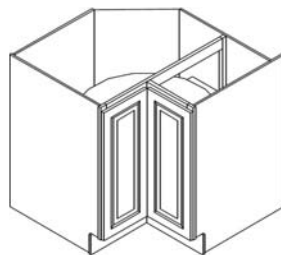

EZ Reach Cabinet

LS3612S	822
---------	-----

- LS3612S: Bi-Fold Door, includes fixed shelf.
- Not Soft Closing Doors

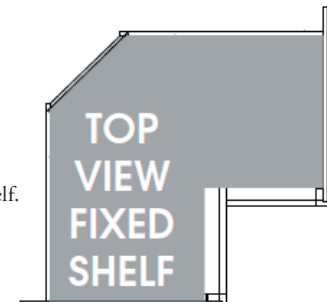

Angle Base

AB24 (Base)	838
-------------	-----

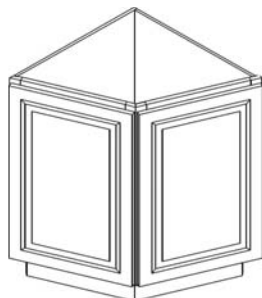

Tall Cabinets

24"W -36"W = 2 Butt Doors (2 doors that open towards each other not separated by a center stile.)

Oven Cabinets

OC3384B	1796
OC3390B	1935
OC3396B	2075

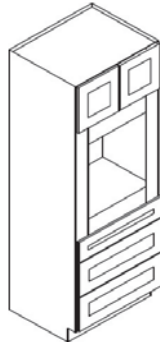

Wall Pantries

WP1584 ¹	976
WP1590 ¹	1048
WP1596 ¹	1119
WP1884	1093
WP1890	1174
WP1896	1254
WP2484B	1368
WP2490B	1473
WP2496B	1574



WP15XX & WP18XX

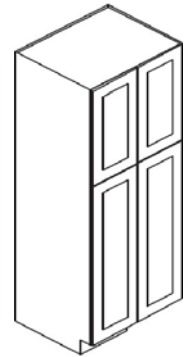

WP24XX

1. WP15XX not available in KE

Silver Pricing

Decor Doors and Panels

End Decorative Doors

EPW1230D	127
EPW1236D	156
EPW1242D	188
EPB24D	321



Dishwasher Panels With 3" return

DWR33412	162
----------	-----

Edge not finished without 3" return



Finished Back Panels and Bead Board

FBP483614(1) ¹	192
FBP369614(1) ¹	323
FBP489614(1)	341
BP48341214	321



FBPXXXXXX(1)

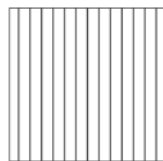

BP48341214

*1. Not available in KE

- Finished Back Panel an Bead Board finished on one side
- BP = 1/4" thick bead board panel

Refrigerator End Panels

REP2484-3/4"	422
REP2496-3/4"	483
REP2484(3)-3/4"	489
REP2496(3)-3/4"	584
REP3096(3)-3/4"	792



Without (3) Return

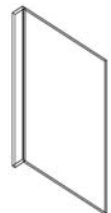

With (3) Return

- (3) = 3" Return
- REP24XX and REP24XX(3) have 2 finished edges usable without 3" return
- REP3096(3)-3/4 has 1 finished edge usable with or without 3" return

Pull Outs

Trash Can Pull Out

TCR21-2	679
---------	-----

TCR21-2 Fits B18 or B21 Sold Separately

- Full Extension, not soft closing
- Includes 2 plastic cans approx 29qt capacity

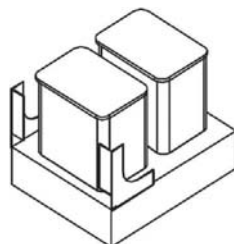

Roll Out Trays

15RT-DR	178
18RT-DR	200
24RT-DR	218
27RT-DR	240
30RT-DR	263
33RT-DR	319
36RT-DR	376

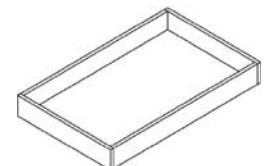

Fillers, Trim, Moldings, Legs, Corbels and Appliques

Valances

VAS48	85
VAD3612	232
VAD4212	293
VAD4812	368

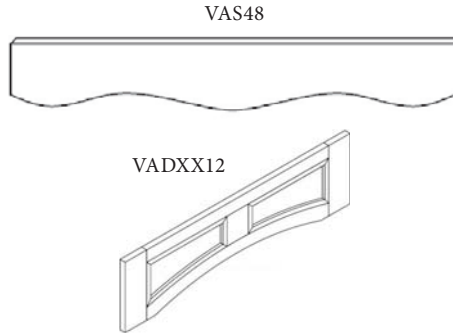

Light Rail Moldings

LRM8	164
TLRM8	400

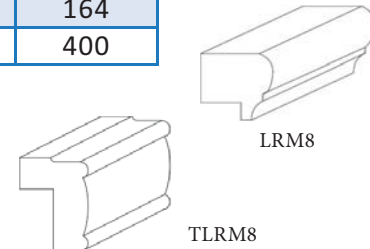

Corner Moldings

SC1-3 (SM)	40
SC4 (ICM)	59
SC5 (OCM)	57
SC6 (SM)	65
SC8 (BM)	61

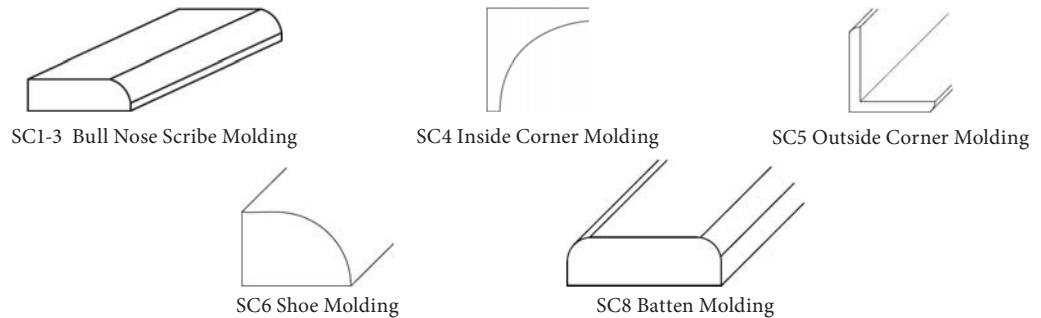

Crown Moldings

CM96	149
CM96-4	240
CM96C-4	329

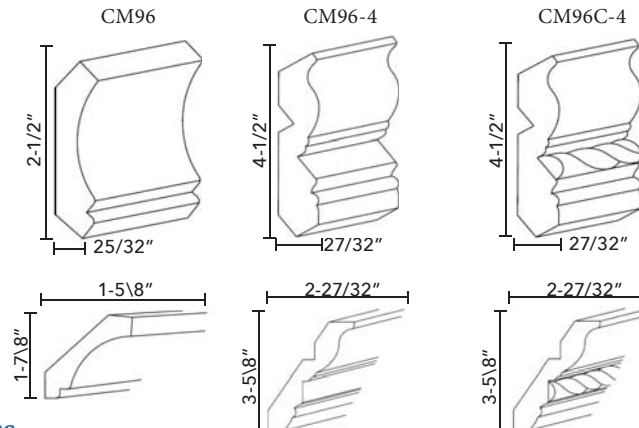

Toe Kick

TK8	99
-----	----

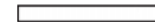

Base Board Molding

BM4-1/2"-5/8"	234
---------------	-----

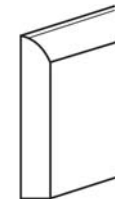

Wall and Base Fillers

WF3-3/4	44
WF336-3/4	55
WF342-3/4	69
WF384-3/4	127
WF396-3/4	149
WF6-3/4	91
WF642-3/4	133
WF696-3/4	293
BF3-3/4	73
BF6-3/4	123
A30WF	73
A36WF	91
A42WF	103
A3BF	99
A6BF ¹	206

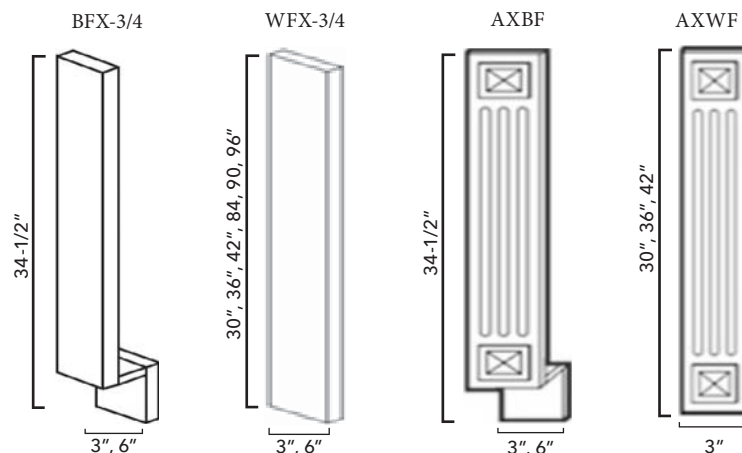

1. Not available in KE

Fillers, Trim, Moldings, Legs, Corbels and Appliques

Silver Pricing

Decor Legs

TP3/WF34-1/2"	418
LEG81 ¹	354
LEG82 ¹	335
LEG-SMALL51 ¹	69
LEG-SMALL52 ²	83

1. Only available in KM
2. Not available in KE

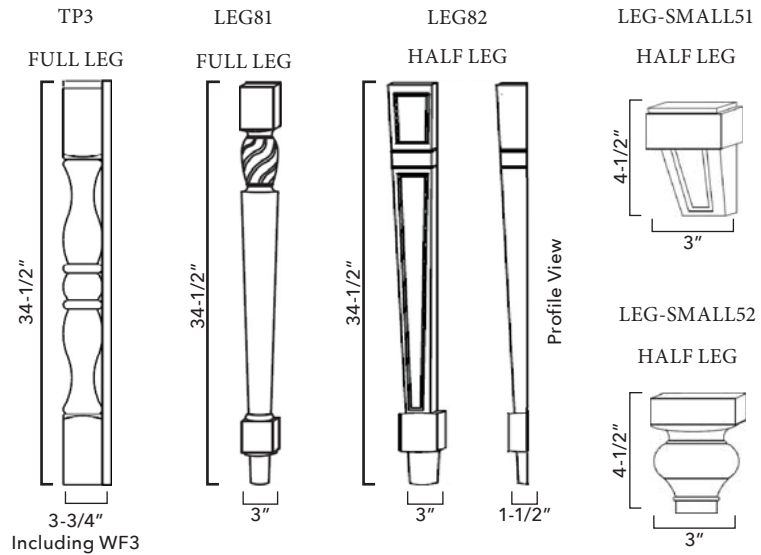

Corbels & Appliques

DOA ¹	410
CORBEL54	131
CORBEL55 ¹	228
CORBEL56 ¹	257
CORBEL57 ²	400
CORBEL58 ¹	345
CORBEL59	192
CORBEL60S ²	364
CORBEL60L ²	788

1. Only available in KM
2. Not available in KE

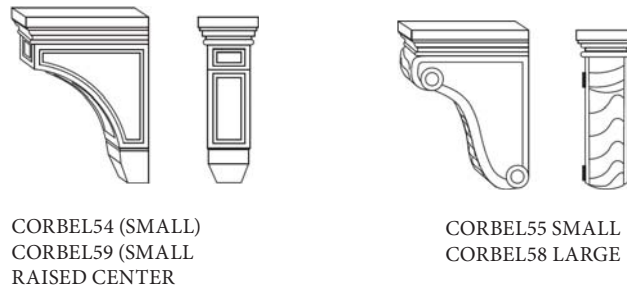

DOA

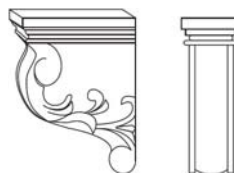

CORBEL56 SMALL
CORBEL57 LARGE



CORBEL60S SMALL
CORBEL60L LARGE

Vanities

24"W -36"W = 2 Butt Doors (2 doors that open towards each other not separated by a center stile.)

Vanity Sink Bases With Drawers

S3021DL-34-1/2"	749
S3021DR-34-1/2"	749
S3621BDL-34-1/2"	838
S3621BDR-34-1/2"	838
S4821B12D-34-1/2"	1244
S6021B12D-34-1/2"	1357

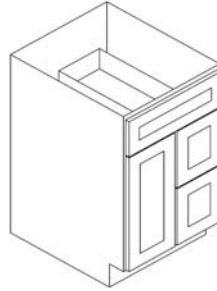

S3021DR

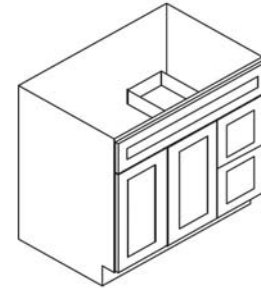

S3621BDR

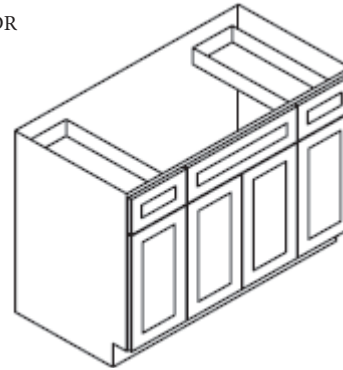

S4821B & S6021B

Vanity Sink Bases Without Drawers

S2421B-30"H	432
S2421B-34-1/2"	457
S3021B-34-1/2"	535
S3621B-34-1/2"	626

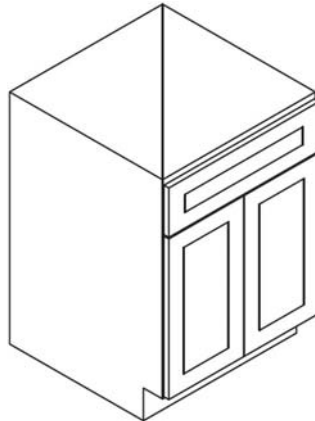

Desk Drawer (Makeup Drawer)

Available in KC and KM only.

SVDU3021-7"	238
-------------	-----

SVDU = Desk Drawer 30"W x 7"H x 20"D

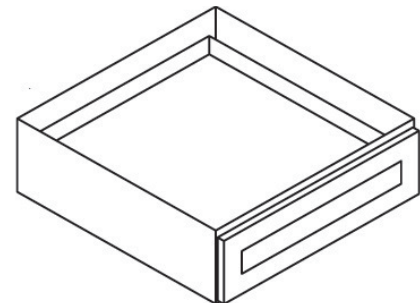

Vanity Drawer Bases

SVB1221-34-1/2"	806
SVB1521-34-1/2"	848
SVB1821-34-1/2"	1065

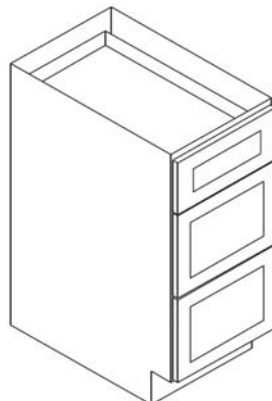



Pricing Gold

Pepper Shaker AP

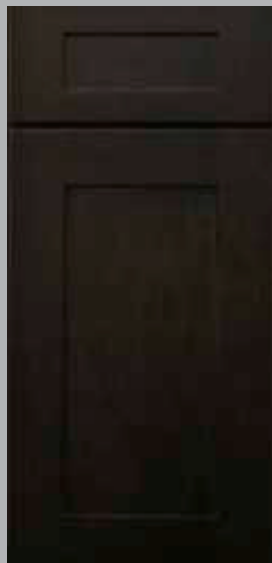

Ice White Shaker AW



GOLD

FEATURES & BENEFITS

Door Style	Ice White Shaker (AW)
Cabinet Style	Full Overlay, Butt Door
Wall & Base	Recessed Square
Front Frame	3/4" Solid Birch
Door Frame	MDF (To Avoid Expansion)
Door Center	MDF (To Avoid Expansion)
Sides (Wall & Base)	1/2" A-Grade Plywood with Wood Veneer
Top & Bottom (Wall)	1/2" A-Grade Plywood with Wood Veneer
Bottom (Base)	3/8" A-Grade Plywood with Wood Veneer
Cabinet Interior	Matches Door Color
Back Panel	1/2" Picture Frame Recess Style
Hinges	Concealed 6-Way Adjustable Soft Close Door Hinges
Connectors	Pre-installed, Color Coated Metal Clip, Won't Tarnish
Shelves	3/4" A-Grade Plywood with Wood Veneer
Drawer Box	Solid Wood 17mm (Close to 3/4")
	Drawer Bottom 3/8" Plywood
	Drawer Length 21"
	Dovetail Construction
	Natural Finish
Drawer Glides	Undermount, Full Extension with Soft Closing Feature
Base Corner Supports	Wood Corner Brackets with Wood I-Beam Construction

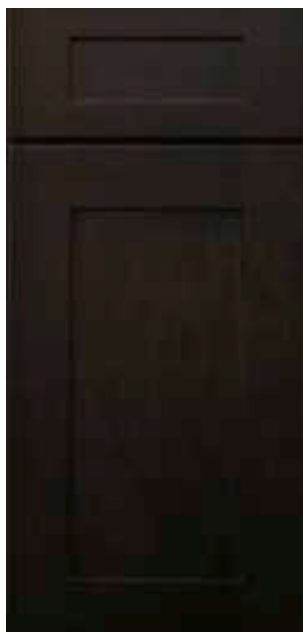

Door Style	Pepper Shaker (AP)
Cabinet Style	Full Overlay, Butt Door
Wall & Base	Recessed Square
Front Frame	3/4" Solid Birch
Door Frame	3/4" Solid Birch
Door Center	MDF with Birch Veneer
Sides (Wall & Base)	1/2" A-Grade Plywood with Wood Veneer
Top & Bottom (Wall)	1/2" A-Grade Plywood with Wood Veneer
Bottom (Base)	3/8" A-Grade Plywood with Wood Veneer
Cabinet Interior	Matches Door Color
Back Panel	1/2" Picture Frame Recess Style
Hinges	Concealed 6-Way Adjustable Soft Close Door Hinges
Connectors	Pre-installed, Color Coated Metal Clip, Won't Tarnish
Shelves	3/4" A-Grade Plywood with Wood Veneer
Drawer Box	Solid Wood 17mm (Close to 3/4")
	Drawer Bottom 3/8" Plywood
	Drawer Length 21"
	Dovetail Construction
	Natural Finish
Drawer Glides	Undermount, Full Extension with Soft Closing Feature
Base Corner Supports	Wood Corner Brackets with Wood I-Beam Construction

Wall Cabinets

24"W -36"W = 2 Butt Doors (2 doors that open towards each other not separated by a center stile.)

Wall Cabinets

30" Wall		36" Wall		42" Wall	
W0930	242	W0936	307	W0942	341
W1230	269	W1236	325	W1242	360
W1530	293	W1536	354	W1542	392
W1830	325	W1836	394	W1842	432
W2130	394	W2136	471	W2142	521
W2430B	420	W2436B	501	W2442B	562
W2730B	459	W2736B	568	W2742B	654
W3030B	475	W3036B	614	W3042B	725
W3330B	511	W3336B	652	W3342B	766
W3630B	543	W3636B	683	W3642B	814

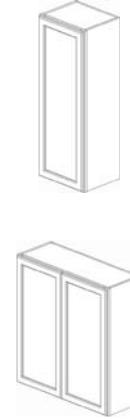

Bridge Cabinets

12" Wall		15" Wall		18" Wall		24" Wall	
W3012B	273	W2415B	275	W2418B	293	W2424B	376
W3312B ¹	291	W3015B	307	W3018B	337	W3024B	422
W3612B	307	W301524B	414	W301824B	509	W302424B	499
W361224B	414	W3315B	331	W3318B	360	W3324B	452
W1512 ¹	152	W331524B	436	W331824B	515	W332424B	531
W1812 ¹	188	W3615B	337	W3618B	384	W3624B	485
W2412 ¹	259	W361524B	459	W361824B	521	W362424B	564
WDC2412 ¹	279						

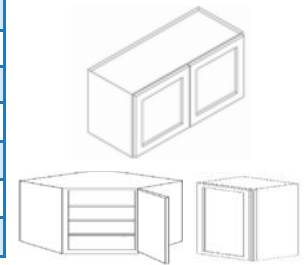

1. Not available in AP

Wall Diagonal Corner

WDC2430	606
WDC2436	758
WDC2442	804
WDC273615	1172
WDC274215	1404

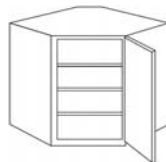

Wall Corner Cabinet

WSQ2430	960
WSQ2436	1151
WSQ2442	1382



Door is not soft closing. Bi-fold doors.

Wall Cabinet-2 Built in Drawers

Not available in AP	
W2D1848	760
W2D1854	887
W2D1860	1012

- Drawers are not soft-closing
- Glass Doors are available for this unit W18XXGD

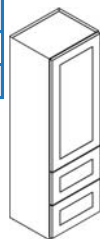

Wine Rack

W3018WR	398
---------	-----

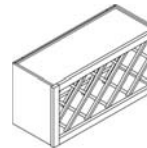

Wall End Shelf Open Shelves

WES530	182
WES536	218
WES542	257

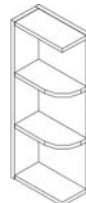

Microwave Oven

MWO3018PM-12	337
--------------	-----



Angle Wall

AW30	412
AW36	495
AW42	580



Wall Cubes

Not Available in AP

WC630	305
WC636	360
WC642	414

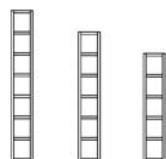

Glass Doors No Mullion

Sizes on page G2



Gold Pricing

Base Cabinets

24"W -36"W = 2 Butt Doors (2 doors that open towards each other not separated by a center stile.)

Sink Bases

SB24B	568
SB27B	596
SB30B	616
SB33B	638
SB36B	665
SB42B ¹	859

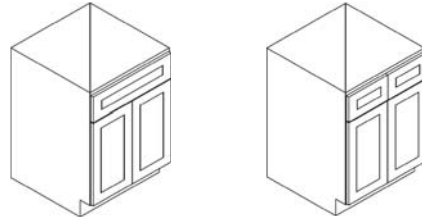

SB24B, SB27B and SB30B SB33B, SB36B, and SB42B

1. Not available in AP

Base Diagonal Corner Sink

BDCF36	1101
BDCF36K-FL	331

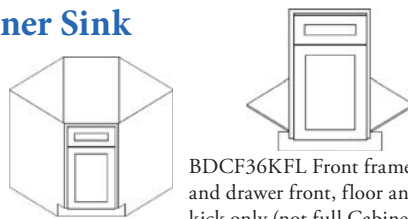

BDCF36KFL Front frame, door and drawer front, floor and toe kick only (not full Cabinet)

Lazy Susan

LS3309	1093
LS3612	1180

- LS3309 and LS3612: Bi-Fold Door, 2 independently spinning trays.
- Not soft closing doors.

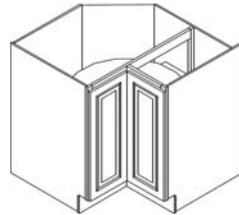

EZ Reach Cabinet

LS3612S	1044
---------	------

- LS3612S: Bi-Fold Door, includes fixed shelf.
- Not Soft Closing Doors

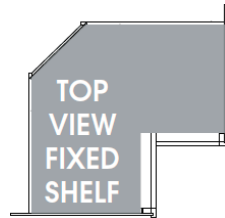

Base Blind Corner

BBLC39/42-36"W	846
BBLC42/45-39"W	856
BBLC45/48-42"W	865

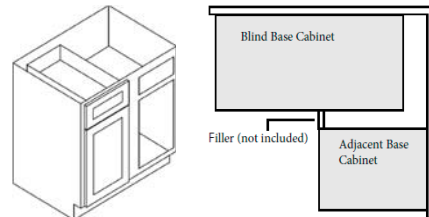

Base Transitional Cabinets

BTC12L	475
BTC12R	475

Base Transitional Left Shown

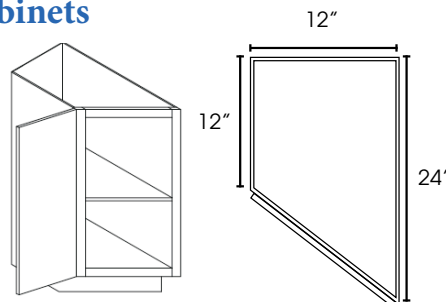

Farm Sink Bases

FSB30B ¹	877
FSB33B ¹	917
FSB36B	955

1. Not available in AP

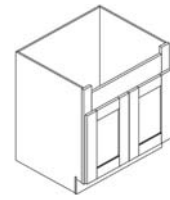

Base Cabinets

B09	400
B12	452
B15	473
B18	495
B21	560
B24B	602
B27B	648
B30B	755
B33B	790
B36B	824

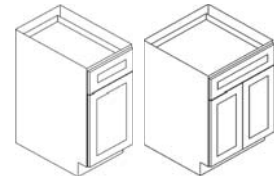

B09-B21 B24B-B30B

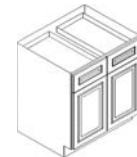

B33B and B36B

Drawer Base Cabinets

DB12(3)	792
DB15(3)	826
DB18(3)	846
DB21(3)	871
DB24(3)	915
DB30(3)	1517
DB36(3)	1553

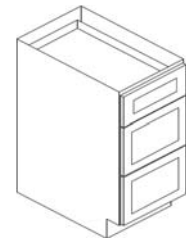

Microwave Base Cabinet

B30MW/(30"W)	778
--------------	-----

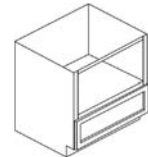

Base with Spice Pull Out

BFP09	988
-------	-----

- Side Mount Full Extension Drawer Track. Not soft closing
- Includes cabinet and spice rack insert (2 middle racks are adjustable)

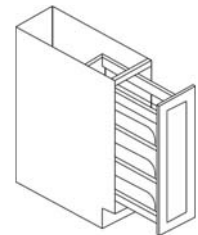

Angle Base

AB24 (Base)	1046
-------------	------

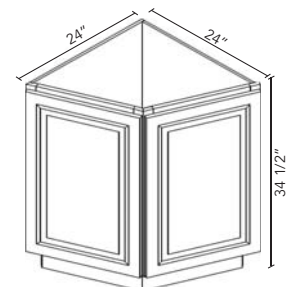

Tall Cabinets

24"W -36"W = 2 Butt Doors (2 doors that open towards each other not separated by a center stile.)

Oven Cabinets

OC3384B	2226
OC3390B	2404
OC3396B	2565
OM3384B ¹	2101
OM3390B ¹	2268
OM3396B ¹	2422

1. Not available in AP

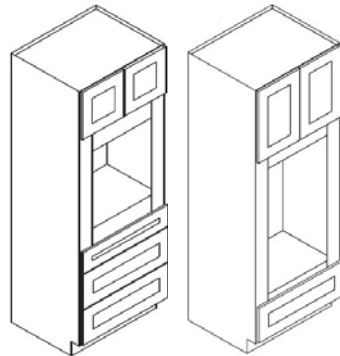

OC33XX

OM33XX

Wall Pantries

WP1584	1218
WP1590	1307
WP1596	1396
WP1884	1364
WP1890	1465
WP1896	1563
WP2484B	1707
WP2490B	1834
WP2496B	1963

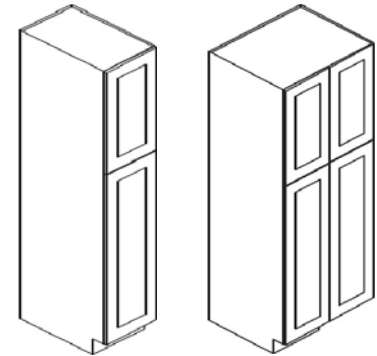

WP15XXX & WP18XX

WP24XX

Decor Doors and Panels

End Decorative Doors

EPW1230D	149
EPW1236D	182
EPW1242D	218
EPB24D	378
EPWP2484(2)	479
EPWP2490(2)	541
EPWP2496(2)	606

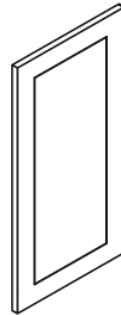

Dishwasher Panels With 3" Return

DWR33412	162
----------	-----



Finished Back Panels and Bead Board

FBP483614(1)	192
FBP369614(1)	323
FBP489614(1)	341
BP48341214	321



FBPXXXXXX(1)

- Finished Back Panel and Bead Board finished on one side
- BP = 1/4" thick bead board panel

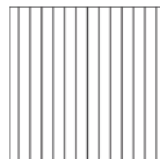

BP48341214

Refrigerator End Panels

REP2484-3/4"	422
REP2496-3/4"	483
REP2484(3)-3/4"	489
REP2496(3)-3/4"	584
REP3096(3)-3/4"	792

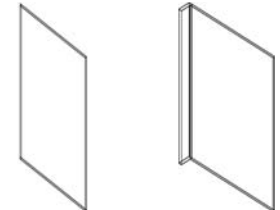

Without (3) Return With (3) Return

- (3) = 3" Return
- REP24XX and REP24XX(3) have 2 finished edges usable without 3" return
- REP3096(3)-3/4 has 1 finished edge usable with or without 3" return

Gold Pricing

Pull Outs

Trash Can Pull Out

TCR21-2	679
---------	-----

TCR21-2 Fits B18 or B21 Sold Separately

- Full Extension, not soft closing
- Includes 2 plastic cans approx 29qt capacity

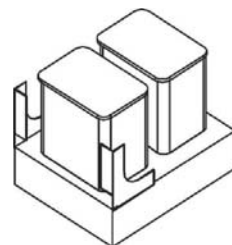

Roll Out Trays

15RT-DR	178
18RT-DR	200
24RT-DR	218
27RT-DR	240
30RT-DR	263
33RT-DR	319
36RT-DR	376

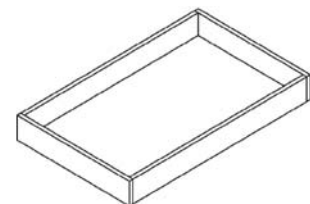

Fillers, Trim, Moldings, Legs, Corbels and Appliques

Valances

VAS48	85
VAD3612	232
VAD4212	293
VAD4812	368
VAL48S	180
VAL54S	200

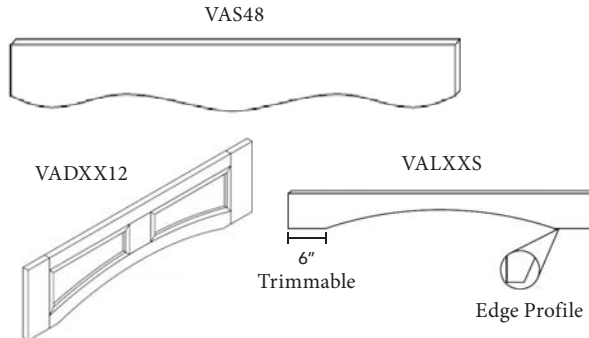

Light Rail Moldings

LRM8	164
TLRM8	400

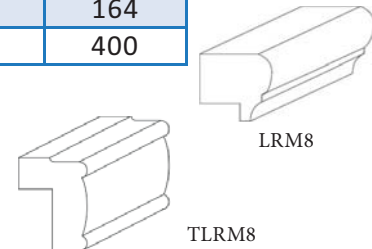

Corner Moldings

SC1-3 (SM)	40
SC4 (ICM)	59
SC5 (OCM)	57
SC6 (SM) ¹	65
SC8 (BM) ¹	61

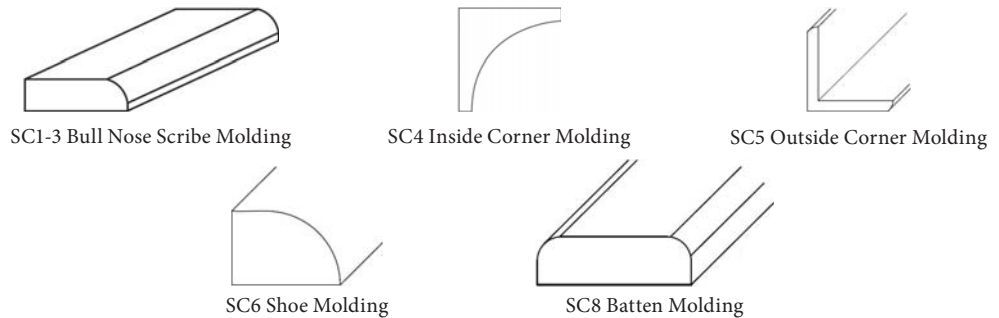

1. Not available in AP

Crown Moldings

CM96	149
CM96-4	240
CM96C-4 ¹	329
CM96E-4	315
CM96H-4	240
CM96K-4	283

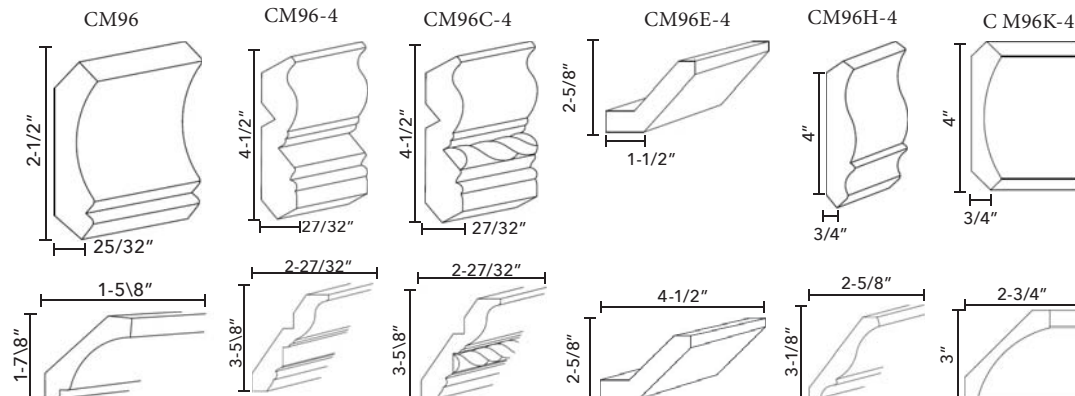

1. Not available in AP

Toe Kick

TK8	99
-----	----

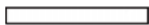

Base Board Molding

BM4-1/2"-5/8"	234
---------------	-----

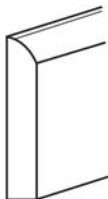

Range Hood

AWH36	1034
CWH36 ¹	1230

Not available in AP

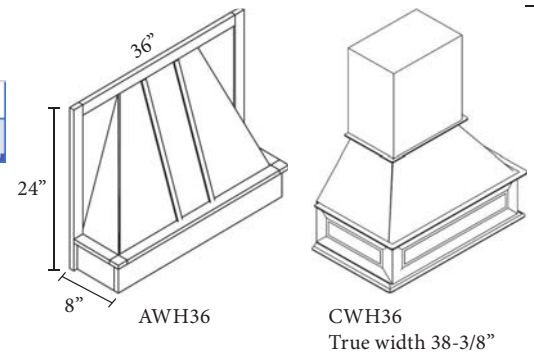

Fillers, Trim, Moldings, Legs, Corbels and Appliques

Wall and Base Fillers

WF3-3/4	44
WF336-3/4	55
WF342-3/4	69
WF384-3/4	127
WF396-3/4	149
WF6-3/4	91
WF642-3/4	133
WF696-3/4	293
BF3-3/4	73
BF6-3/4	123
A30WF	73
A36WF	91
A42WF	103
A3BF	99
A6BF	206
CLB334-1/2 ¹	343
CLW330 ¹	222
CLW336 ¹	265
CLW342 ¹	309
CLW396 ¹	1030

1. Not available in AP

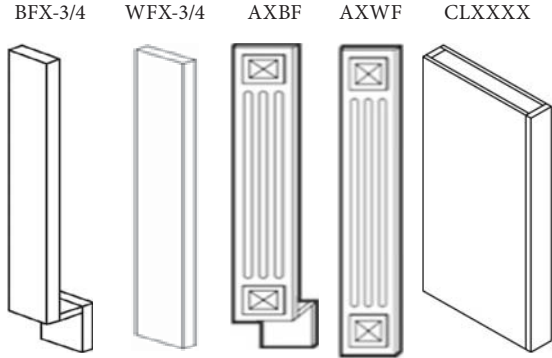

Boxed columns
can be used as
floating shelves

Overlay Fillers

OLF330	44
OLF336	55
OLF342	69
OLF630	83
OLF636	109
OLF642	121
OLF384	192
OLF390	228
OLF396	261

- 3/4" Solid Wood
- Outer Profile Matches Door Color
- Mounted to Wall Filler, Base Filler or Column Boxes. Filler Sold Separately

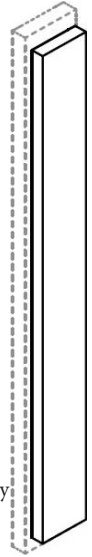

Decor Legs

TP3/WF34-1/2"	418
LEG75 B3x3 ¹	505
LEG81	354
LEG82	335
LEG83 ¹	392
POLE75-B3 ¹	459
POLE75-W330 ¹	255
POLE75-W336 ¹	281
POLE75-W342 ¹	323
POLE75-T384 ¹	556
POLE75-T390 ¹	588
POLE75-T396 ¹	622

1. Not available in AP

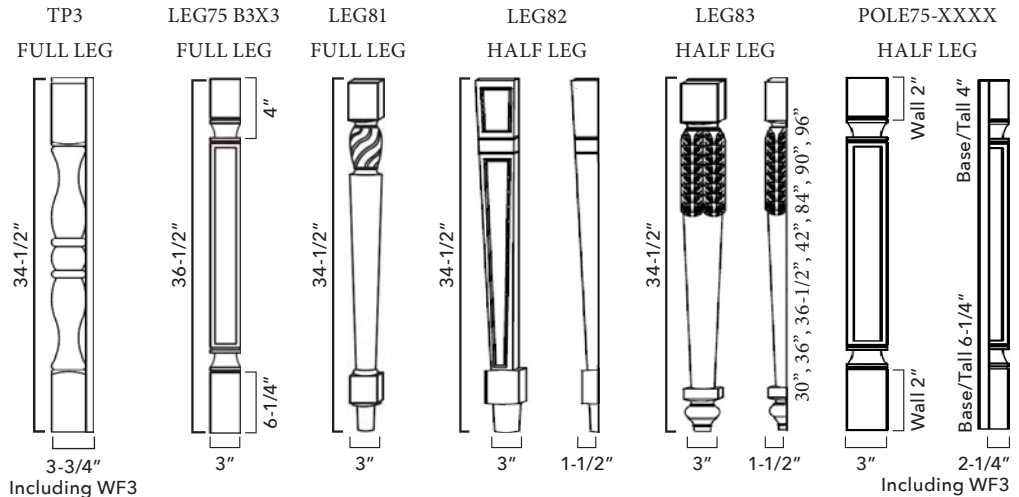

Corbels & Appliques

DOA	410
CORBEL56 ¹	257
CORBEL57 ¹	400
CORBEL58 ²	345
CORBEL59	192
CORBEL60S ¹	364
CORBEL75S ¹	321
CORBEL75M ¹	438
CORBEL75L ¹	465

1. Not available in AP
2. Not available in AW

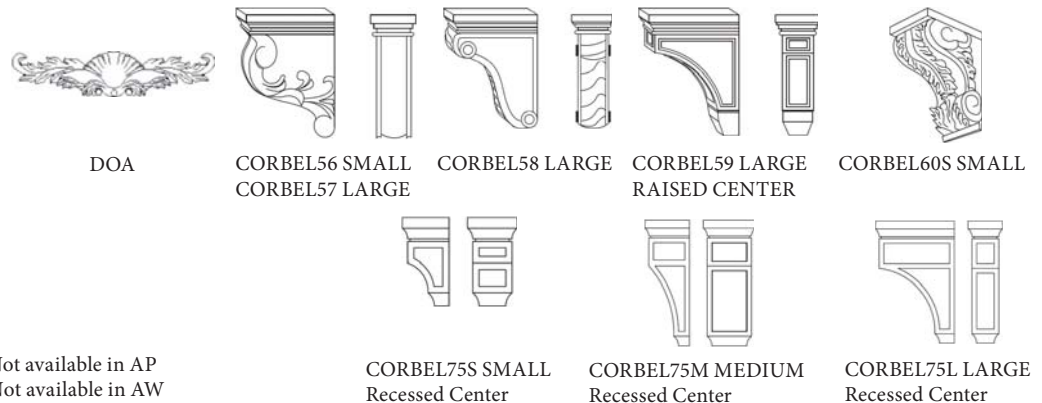

Gold Pricing

Vanities

24"W -36"W = 2 Butt Doors (2 doors that open towards each other not separated by a center stile.)

Vanities with Drawers

S3021DL-34-1/2"	883
S3021DR-34-1/2"	883
S3621BDL-34-1/2"	1006
S3621BDR-34-1/2"	1006
S4821B12D-34-1/2"	1355
S6021B12D-34-1/2"	1519

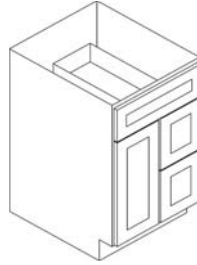

S3021DR

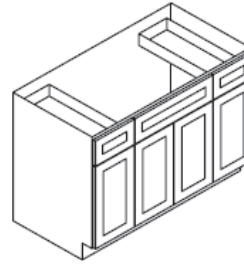

S4821B and S6021B

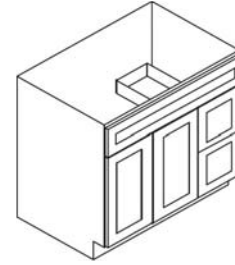

S3621BDR

Vanities without Drawers

S2421B-34-1/2"	489
S3021B-34-1/2"	620
S3621B-34-1/2"	743

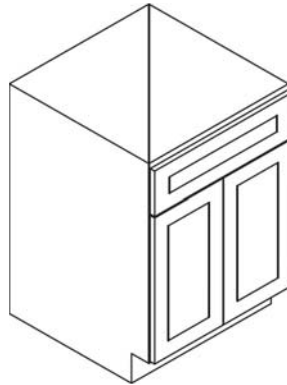

Wall Cabinet-2 Built in Drawers

Not available in AP

W2D1848	760
W2D1854	887
W2D1860	1012

- Drawers are not soft-closing
- Glass Doors are available for this unit W18XXGD
- Listed in Wall Cabinet Section in both the order form and on the Online ordering

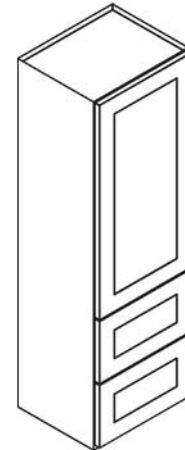

Vanity Drawer Bases

SVB1221-34-1/2"	933
SVB1521-34-1/2"	976
SVB1821-34-1/2"	1065

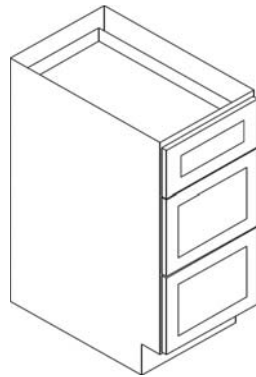

Desk Drawer (Makeup Drawer)

SVDU3021-7"	271
-------------	-----

SVDU = Desk Drawer 30"W x 7"H x 20"D

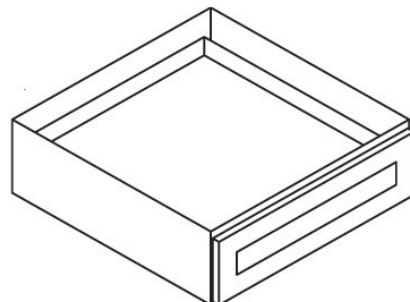



Pricing Platinum



PLATINUM

FEATURES & BENEFITS

Door Style	Lait Grey Shaker (AB)	Xterra Blue Shaker (AX)	Townsquare Grey (TS) Uptown White (TW)	Greystone Shaker (AG)	Gramercy White (GW) Signature Pearl (SL)
Cabinet Style	Full Overlay, Butt Door				
Wall & Base	Recessed Square				Raised Square
Front Frame	3/4" Solid Birch				
Door Frame	MDF (To Avoid Expansion)		3/4" Solid Birch		
Door Center	MDF (To Avoid Expansion)			MDF with Maple Veneer	MDF (To Avoid Expansion)
Sides (Wall & Base)	1/2" A-Grade Plywood with Wood Veneer				
Top & Bottom (Wall)	1/2" A-Grade Plywood with Wood Veneer				
Bottom (Base)	3/8" A-Grade Plywood with Wood Veneer				
Cabinet Interior	Matches Door Color				
Back Panel	1/2" Picture Frame Recess Style				
Hinges	Concealed 6-Way Adjustable Soft Close Door Hinges				
Connectors	Pre-installed, Color Coated Metal Clip, Won't Tarnish				
Shelves	3/4" A-Grade Plywood with Wood Veneer				
Drawer Box	Solid Wood 17mm (Close to 3/4")				
	Drawer Bottom 1/2" Plywood				
	Drawer Length 21"				
	Dovetail Construction				
	Natural Finish				
Drawer Glides	Undermount, Full Extension with Soft Closing Feature				
Base Corner Supports	Wood Corner Brackets with Wood I-Beam Construction				



Wall Cabinets

24"W -36"W = 2 Butt Doors (2 doors that open towards each other not separated by a center stile.)

Wall Cabinets

30" Wall		36" Wall		42" Wall	
W0930	250	W0936	317	W0942	349
W1230	277	W1236	335	W1242	370
W1530	303	W1536	364	W1542	402
W1830	335	W1836	404	W1842	446
W2130	404	W2136	483	W2142	537
W2430B	434	W2436B	517	W2442B	578
W2730B	473	W2736B	586	W2742B	675
W3030B	489	W3036B	632	W3042B	747
W3330B	525	W3336B	673	W3342B	788
W3630B	562	W3636B	703	W3642B	840

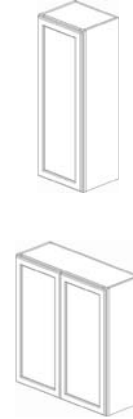

Bridge Cabinets

12" Wall		15" Wall		18" Wall		24" Wall	
W3012B	281	W2415B	281	W2418B	303	W2424B	388
W3312B	301	W3015B	315	W3018B	347	W3024B	436
W3612B	315	W301524B	428	W301824B	525	W302424B	515
W361224B	426	W3315B	341	W3318B	370	W3324B	467
W1512 ¹	156	W331524B	450	W331824B	531	W332424B	549
W1812 ¹	194	W3615B	347	W3618B	394	W3624B	499
W2412 ¹	269	W361524B	473	W361824B	537	W362424B	582
WDC24 ¹	287						

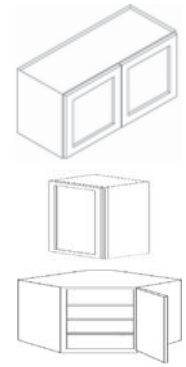

1. Available in AG and TW Only

Wall Diagonal Corner

WDC2430	624
WDC2436	782
WDC2442	830
WDC273615	1182
WDC274215	1414

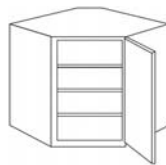

Wall Corner Cabinet

WSQ2430	960
WSQ2436	1151
WSQ2442	1382

Door is not soft closing. Bi-fold doors.



Wall Cabinet-2 Built in Drawers

W2D1848	760
W2D1854	887
W2D1860	1012

- Drawers are not soft-closing
- Glass Doors are available for this unit W18XXGD

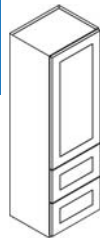

Wall End Shelf Open Shelves

WES530	182
WES536	218
WES542	257

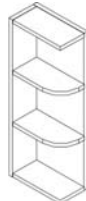

Wine Rack

W3018WR	398
---------	-----

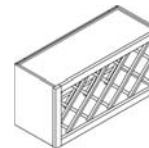

Wall Cubes

WC630	305
WC636	360
WC642	414

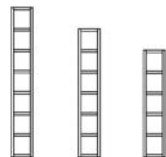

Microwave Oven

MWO3018PM-12	337
--------------	-----

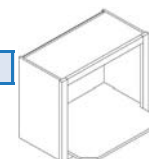

Angle Wall

AW30	426
AW36	511
AW42	598



Platinum Pricing

Wall Cabinets



Without Mullion

Glass Doors With and without Mullions

Styles on page G3



With Mullion

Base Cabinets

24"W -36"W = 2 Butt Doors (2 doors that open towards each other not separated by a center stile.)

Sink Bases

SB24B	584
SB27B	612
SB30B	634
SB33B	659
SB36B	681
SB42B	879

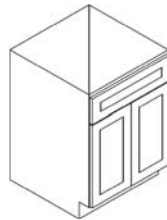

SB24B, SB27B and SB30B

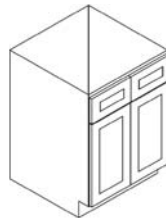

SB33B, SB36B and SB42B

Farm Sink Bases

FSB30B	903
FSB33B	945
FSB36B	986

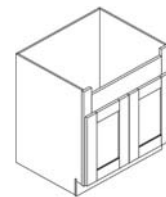

Base Diagonal Corner Sink

BDCF36	1137
BDCF36K-FL	341

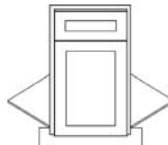

BDCF36KFL Front frame, door and drawer front, floor and toe kick only (not full Cabinet)

Base Cabinets

B09	422
B12	477
B15	497
B18	521
B21	588
B24B	630
B27B	679
B30B	800
B33B	836
B36B	871

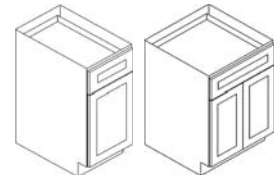

B09-B21

B24B-B30B



B33B and B36B

Lazy Susan

LS3309	1129
LS3612	1220

- LS3309 and LS3612: Bi-Fold Door, 2 independently spinning trays.
- Not soft closing doors.

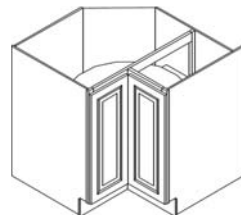

Drawer Base Cabinets

DB12(3)	846
DB15(3)	883
DB18(3)	905
DB21(3)	929
DB24(3)	976
DB30(3)	1539
DB36(3)	1590

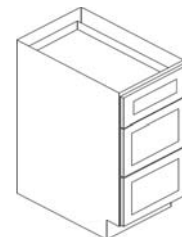

EZ Reach Cabinet

LS3612S	1101
---------	------

- LS3612S: Bi-Fold Door, includes fixed shelf.
- Not Soft Closing Doors

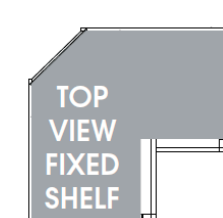

Base Cabinets

Base Blind Corner

BBLC39/42-36"W	883
BBLC42/45-39"W	893
BBLC45/48-42"W	903

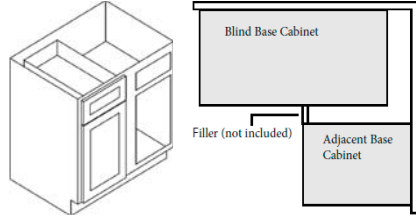

Microwave Base Cabinet

B30MW/(30"W)	800
--------------	-----



Base with Spice Pull Out

BFP09	1002
-------	------

- Side Mount Full Extension Drawer Track. Not soft closing
- Includes cabinet and spice rack

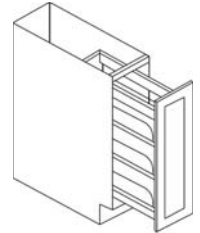

Base Transitional Cabinets

BTC12L	489
BTC12R	489

Base Transitional Left Shown

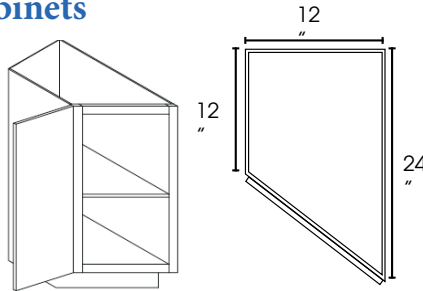

Angle Base

AB24 (Base)	1081
-------------	------

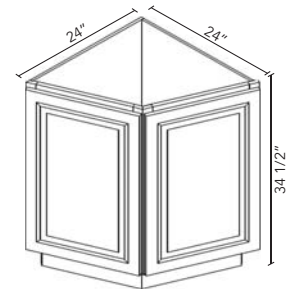

Tall Cabinets

24"W -36"W = 2 Butt Doors (2 doors that open towards each other not separated by a center stile.)

Oven Cabinets

OC3384B	2329
OC3390B	2513
OC3396B	2681
OM3384B	2198
OM3390B	2371
OM3396B	2529

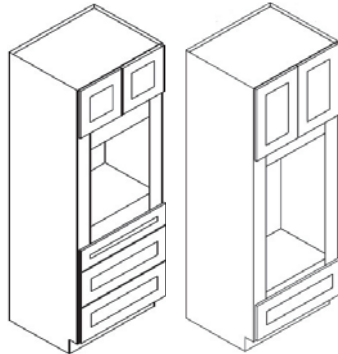

OC33XX

OM33XX

Wall Pantries

WP1584	1254
WP1590	1349
WP1596	1442
WP1884	1406
WP1890	1511
WP1896	1616
WP2484B	1761
WP2490B	1895
WP2496B	2028

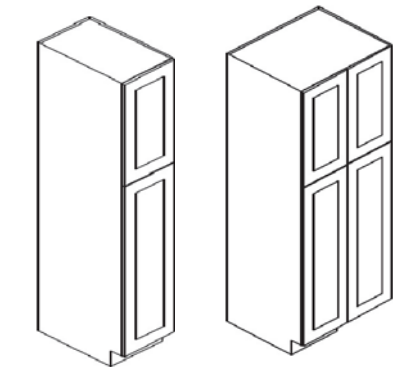

WP15XX & WP18XX

WP24XX

Platinum Pricing

Decor Doors and Panels

End Decorative Doors

EPW1230D	154
EPW1236D	188
EPW1242D	224
EPB24D	390
EPWP2484(2)	483
EPWP2490(2)	543
EPWP2496(2)	596

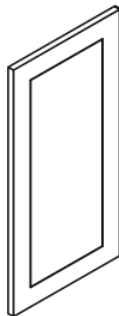

Lattice Doors Available in GW, SL and TW

SB30B-ND-SP	592
SB33B-ND-SP	620
SB36B-ND-SP	650

Lattice doors only (2 pieces per pack) cabinet sold separately

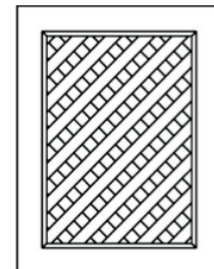

Finished Back Panels and Bead Board

FBP483614(1)	192
FBP369614(1)	323
FBP489614(1)	341
BP48341214	321

- Finished Back Panel and Bead Board finished on one side
- BP = 1/4" thick bead board panel

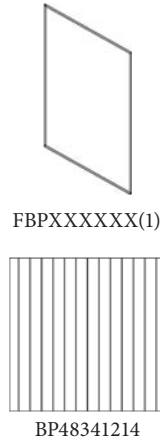

Dishwasher Panels With 3" Return

DWR33412	162
----------	-----

Refrigerator End Panels

REP2484-3/4"	422
REP2496-3/4"	483
REP2484(3)-3/4"	489
REP2496(3)-3/4"	584
REP3096(3)-3/4"	792

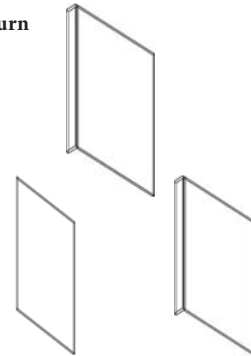

- (3) = 3" Return
- REP24XX and REP24XX(3) have 2 finished edges usable without 3" return
- REP3096(3)-3/4 has 1 finished edge usable with or without 3" return

Pull Outs

Trash Can Pull Out

TCR21-2	679
---------	-----

TCR21-2 Fits B18 or B21 Sold Separately

- Full Extension, not soft closing
- Includes 2 plastic cans approx 29qt capacity

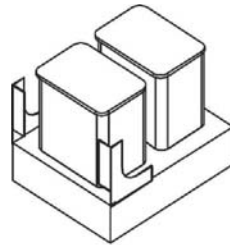

Roll Out Trays

15RT-DR	178
18RT-DR	200
24RT-DR	218
27RT-DR	240
30RT-DR	263
33RT-DR	319
36RT-DR	376

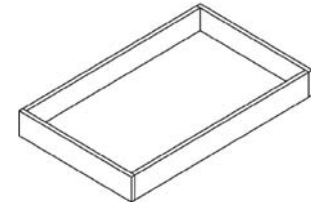

Fillers, Trim, Moldings, Legs, Corbels and Appliques

Valances

VAS48 ¹	85
VAD3612 ²	232
VAD4212 ²	293
VAD4812 ²	368
VAL48B ³	228
VAL54B ³	248
VAL48S ⁴	228
VAL54S ⁴	248

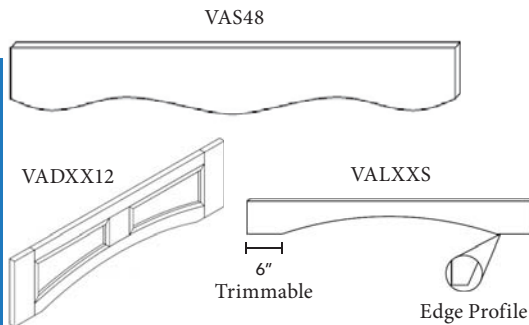

Light Rail Moldings

LRM8	164
TLRM8	400

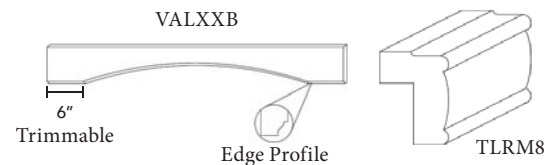

1. Available in SL 2. Available in GW and SL 3. Available in AX, GW, SL, TW 4. Available in AB, AG, AX, TS

Corner Moldings

SC1-3 (SM)	40
SC4 (ICM)	59
SC5 (OCM)	57
SC6 (SM)	65
SC8 (BM)	61

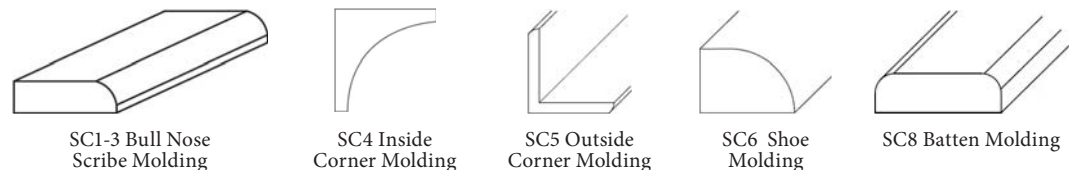

Fillers, Trim, Moldings, Legs, Corbels and Appliques

Crown Moldings

CM96	149
CM96-4 ¹	240
CM96B-4 ²	329
CM96C-4 ³	329
CM96E-4 ⁴	315
CM96H-4 ⁵	240
CM96K-4 ⁵	283

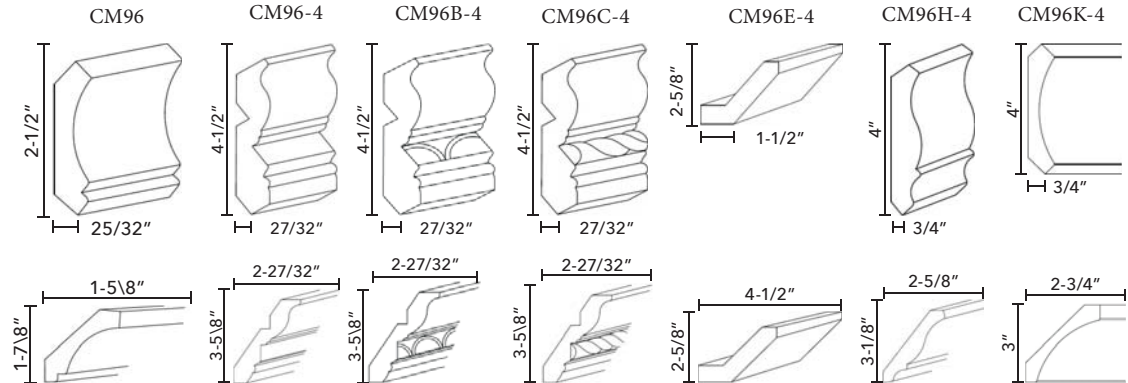

1. Available in AB, AX, GW, SL, TW
2. Available in SL
3. Available in GW, SL, TW
4. Available in GW, TW
5. Available in AB, AG, AX, GW, TS, TW

Toe Kick

TK8	99
-----	----



Range Hood

AWH36	1034
CWH36	1230

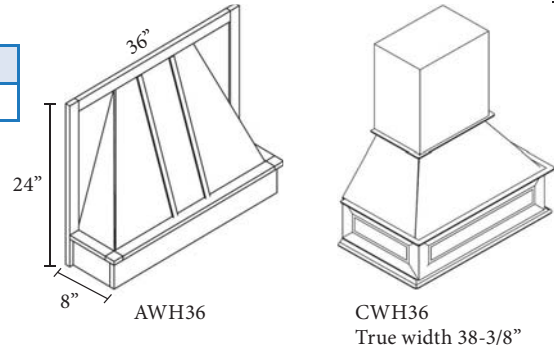

Base Board Molding

BM4-1/2"-5/8"	234
---------------	-----

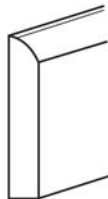

Corbels & Appliques

DOA ¹	410
CORBEL56	257
CORBEL57	400
CORBEL59 ²	192
CORBEL60S	364
CORBEL60L ³	788
CORBEL75S ²	321
CORBEL75M ²	438
CORBEL75L ²	465



DOA



CORBEL56 SMALL
CORBEL57 LARGE

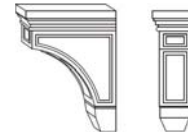

CORBEL59 LARGE
Raised Center



CORBEL60S SMALL
CORBEL60L LARGE



CORBEL75S SMALL
Recessed Center



CORBEL75M MEDIUM
Recessed Center



CORBEL75L LARGE
Recessed Center

1. Available in GW, SL, TW
2. Not available in SL,
3. Available in SL

Platinum Pricing

Fillers, Trim, Moldings, Legs, Corbels and Appliques

Wall and Base Fillers

WF3-3/4	44
WF336-3/4	55
WF342-3/4	69
WF384-3/4	127
WF396-3/4	149
WF6-3/4	91
WF642-3/4	133
WF696-3/4	293
BF3-3/4	73
BF6-3/4	123
A30WF ¹	73
A36WF ¹	91
A42WF ¹	103
A3BF ¹	99
A6BF ¹	206
CLB334-1/2	343
CLW330	222
CLW336	265
CLW342	309
CLW396	1030

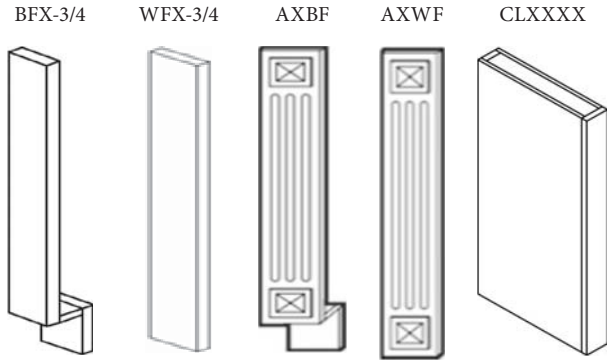

1. Not available in AB, AG, AX, TS

Boxed columns
can be used as
floating shelves

Overlay Fillers

OLF330	44
OLF336	55
OLF342	69
OLF630	83
OLF636	109
OLF642	121
OLF384	192
OLF390	228
OLF396	261

- 3/4" Solid Wood
- Outer Profile Matches Door Color
- Mounted to Wall Filler, Base Filler or Column Boxes. Filler Sold Separately

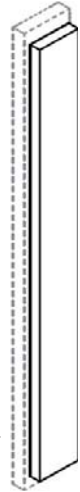

Decor Legs

TP3/WF34-1/2 ⁿ¹	418
LEG75 B3x3 ²	505
LEG81 ¹	354
LEG83 ⁴	292
POLE75-B3 ³	459
POLE75-W330 ³	255
POLE75-W336 ³	281
POLE75-W342 ³	323
POLE75-T384 ³	556
POLE75-T390 ³	588
POLE75-T396 ³	622

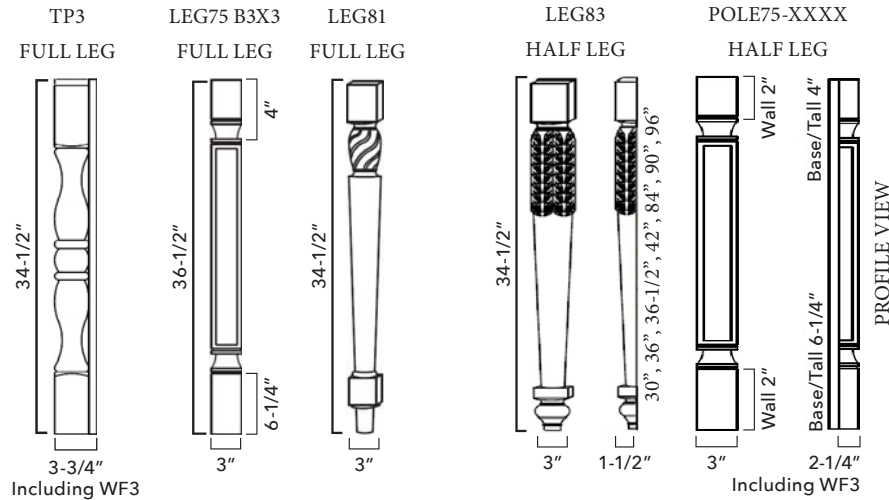

1. Available in GW, SL, TW
2. Available in AB, AG, AX, GW, TS, TW
3. Available in AB, AG, GW, TS, TW
4. Available in GW, SL, TW

Decor Legs SL only

LEG28 B3x3	505
POLE28-B3	459
POLE28-W330	255
POLE28-W336	281
POLE28-W342	323
POLE28-T384	556
POLE28-T390	588
POLE28-T396	622

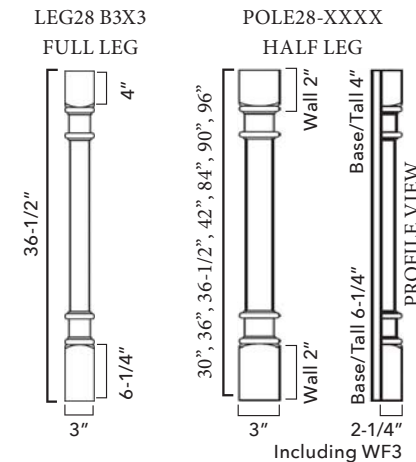

Vanities

24"W -36"W = 2 Butt Doors (2 doors that open towards each other not separated by a center stile.)

Vanities with Drawers

S3021DL-34-1/2"	903
S3021DR-34-1/2"	903
S3621BDL-34-1/2"	1034
S3621BDR-34-1/2"	1034
S4821B12D-34-1/2"	1412
S6021B12D-34-1/2" ¹	1885

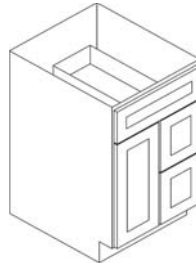

S3021DR

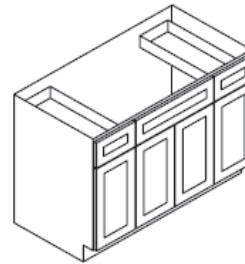

S4821B and S6021B

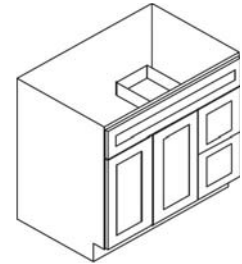

S3621BDR

1. Not available in AB, AX, GW, TW

Vanities without Drawers

S2421B-34-1/2"	505
S3021B-34-1/2"	636
S3621B-34-1/2"	768

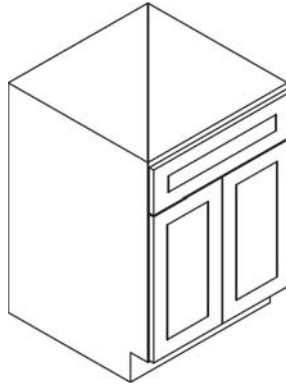

Vanity Drawer Bases

SVB1221-34-1/2"	962
SVB1521-34-1/2"	1006
SVB1821-34-1/2" ¹	1192

1. 18" drawer bases not available in AX, TS, TW

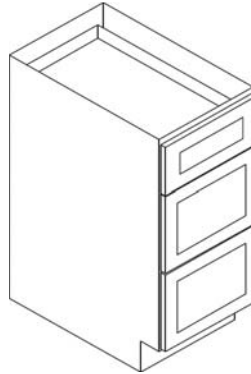

Wall Cabinet-2 Built in Drawers

W2D1848	760
W2D1854	887
W2D1860	1012

- Drawers are not soft-closing
- Glass Doors are available for this unit W18XXGD
- Listed in Wall Cabinet Section in both the order form and on the Online ordering

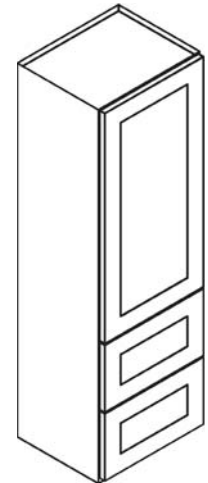

Platinum Pricing

Desk Drawer (Makeup Drawer)

SVDU3021-7"	275
-------------	-----

SVDU = Desk Drawer 30"W x 7"H x 20"D

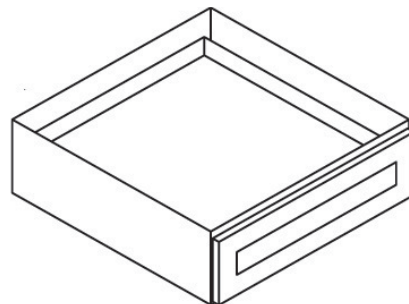



Titanium Prices



Nova Light Grey Shaker AN
Stocked in NJ

Townplace Crema TQ

Midtown Grey TG
Stocked in NJ



TITANIUM

FEATURES & BENEFITS

Door Style	Nova Light Grey Shaker (AN), Midtown Grey (TG)
Cabinet Style	Full Overlay, Butt Door
Wall & Base	Recessed Square
Front Frame	3/4" Solid Eucalyptus Grandis
Door Frame	3/4" Solid Eucalyptus Grandis
Door Center	Solid Eucalyptus Grandis (Reversed Raised Door Panel)
Sides (Wall & Base)	1/2" A-Grade Plywood with Wood Veneer
Top & Bottom (Wall)	1/2" A-Grade Plywood with Wood Veneer
Bottom (Base)	3/8" A-Grade Plywood with Wood Veneer
Cabinet Interior	Matches Door Color
Back Panel	Wall: 1/2" Picture Frame Recess Style
	Base: 1/2" Full Back
Hinges	Concealed 6-Way Adjustable Soft Close Door Hinges
Connectors	Pre-installed, Color Coated Metal Clip, Won't Tarnish
Shelves	3/4" A-Grade Plywood with Wood Veneer
Drawer Box	Solid Wood 17mm (Close to 3/4")
	Drawer Bottom 1/2" Plywood
	Drawer Length 21"
	Dovetail Construction
	Natural Finish
Drawer Glides	Undermount, Full Extension with Soft Closing Feature
Base Corner Supports	Wood Corner Brackets with Wood I-Beam Construction



AN



TG



TQ

Door Style	Townplace Crema (TQ)
Cabinet Style	Full Overlay, Butt Door
Wall & Base	Recessed Square
Front Frame	3/4" Solid Birch
Door Frame	3/4" Solid Birch
Door Center	MDF (To Avoid Expansion) (Reversed Raised Door Panel)
Sides (Wall & Base)	1/2" A-Grade Plywood with Wood Veneer
Top & Bottom (Wall)	1/2" A-Grade Plywood with Wood Veneer
Bottom (Base)	3/8" A-Grade Plywood with Wood Veneer
Cabinet Interior	Matches Door Color
Back Panel	1/2" Picture Frame Recess Style
Hinges	Concealed 6-Way Adjustable Soft Close Door Hinges
Connectors	Pre-installed, Color Coated Metal Clip, Won't Tarnish
Shelves	3/4" A-Grade Plywood with Wood Veneer
Drawer Box	Solid Wood 17mm (Close to 3/4")
	Drawer Bottom 1/2" Plywood
	Drawer Length 21"
	Dovetail Construction
	Natural Finish
Drawer Glides	Undermount, Full Extension with Soft Closing Feature
Base Corner Supports	Wood Corner Brackets with Wood I-Beam Construction

Wall Cabinets

24"W -36"W = 2 Butt Doors (2 doors that open towards each other not separated by a center stile.)

Wall Cabinets

30" Wall		36" Wall		42" Wall	
W0930	281	W0936	356	W0942	392
W1230	311	W1236	376	W1242	414
W1530	339	W1536	408	W1542	450
W1830	376	W1836	452	W1842	501
W2130	452	W2136	541	W2142	602
W2430B	487	W2436B	580	W2442B	648
W2730B	531	W2736B	657	W2742B	758
W3030B	549	W3036B	709	W3042B	838
W3330B	590	W3336B	753	W3342B	883
W3630B	630	W3636B	788	W3642B	941

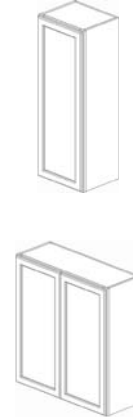

Bridge Cabinets

12" Wall	15" Wall	18" Wall	24" Wall
W3012B	315	W2415B	315
W3312B	335	W3015B	354
W3612B	354	W301524B	481
W361224B	479	W3315B	384
		W331524B	505
		W3615B	390
		W361524B	531
		W2418B	339
		W3018B	390
		W301824B	590
		W3318B	414
		W331824B	596
		W3618B	442
		W361824B	602
		W2424B	436
		W3024B	489
		W302424B	578
		W3324B	523
		W332424B	616
		W3624B	560
		W362424B	652



Wall Diagonal Corner

WDC2430	701
WDC2436	877
WDC2442	931
WDC273615	1325
WDC274215	1584

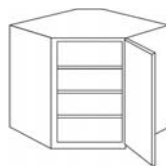

Wall Corner Cabinet

WSQ2430	1075
WSQ2436	1291
WSQ2442	1549

Door is not soft closing. Bi-fold doors.

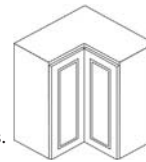

Wall Cabinet-2 Built in Drawers

W2D1848	852
W2D1854	994
W2D1860	1135

- Drawers are not soft-closing
- Glass Doors are available for this unit W18XXGD

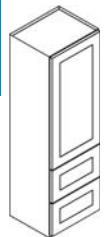

Wall End Shelf Open Shelves

WES530	204
WES536	244
WES542	289

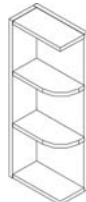

Wine Rack

W3018WR	446
---------	-----

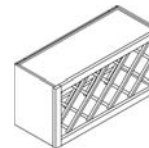

Wall Cubes

WC630	343
WC636	404
WC642	465

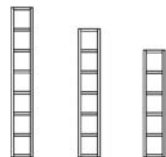

Microwave Oven

MWO3018PM-12	380
--------------	-----



Angle Wall

AW30	479
AW36	574
AW42	671



Wall Cabinets



Without Mullion

Glass Doors With and without Mullions

Styles on page G4



With Mullion

Base Cabinets

24"W -36"W = 2 Butt Doors (2 doors that open towards each other not separated by a center stile.)

Sink Bases

SB24B	654
SB27B	687
SB30B	711
SB33B	739
SB36B	764
SB42B	986

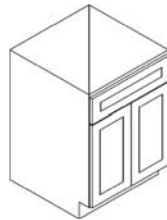

SB24B, SB27B and SB30B

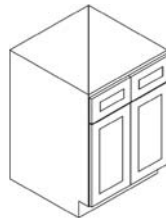

SB33B, SB36B and SB42B

Farm Sink Bases

FSB30B	1012
FSB33B	1061
FSB36B	1105

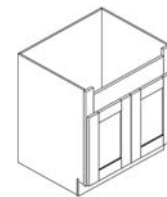

Base Diagonal Corner Sink

BDCF36	1275
BDCF36K-FL	384

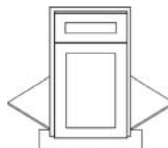
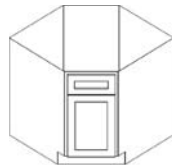

BDCF36KFL Front frame, door and drawer front, floor and toe kick only (not full Cabinet)

Base Cabinets

B09	475
B12	535
B15	558
B18	584
B21	659
B24B	707
B27B	762
B30B	897
B33B	937
B36B	976

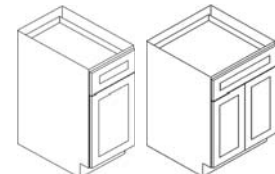

B09-B21

B24B-B30B

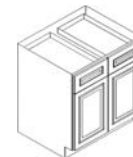

B33B and B36B

Lazy Susan

LS3309	1267
LS3612	1368

- LS3309 and LS3612: Bi-Fold Door, 2 independently spinning trays.
- Not soft closing doors.

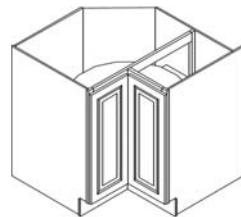

EZ Reach Cabinet

LS3612S	1234
---------	------

- LS3612S: Bi-Fold Door, includes fixed shelf.
- Not Soft Closing Doors

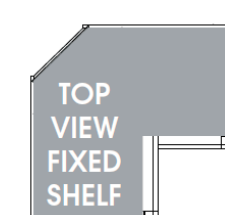

Drawer Base Cabinets

DB12(3)	949
DB15(3)	990
DB18(3)	1014
DB21(3)	1042
DB24(3)	1093
DB30(3)	1725
DB36(3)	1782

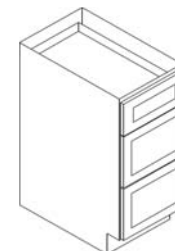

Base Cabinets

Base Blind Corner

BBLC39/42-36"W	990
BBLC42/45-39"W	1002
BBLC45/48-42"W	1012

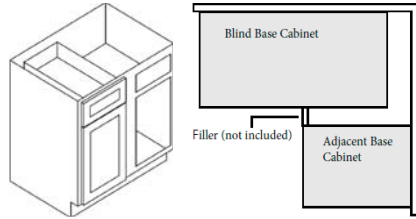

Microwave Base Cabinet

B30MW/(30"W)	897
--------------	-----



Base with Spice Pull Out

BFP09	1123
-------	------

- Side Mount Full Extension Drawer Track. Not soft closing
- Includes cabinet and spice rack

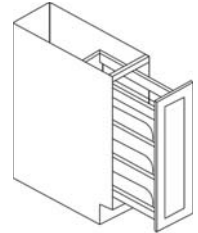

Base Transitional Cabinets

BTC12L	549
BTC12R	549

Base Transitional Left Shown

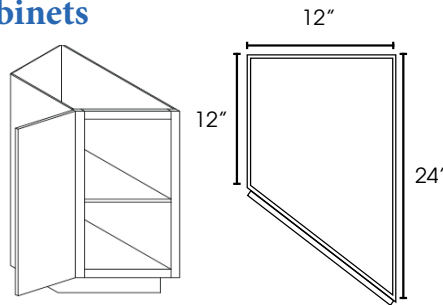

Angle Base

AB24 (Base)	1212
-------------	------

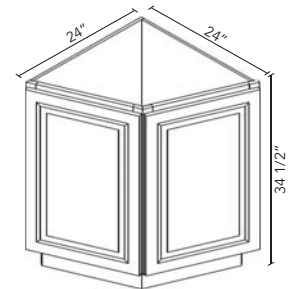

Tall Cabinets

24"W -36"W = 2 Butt Doors (2 doors that open towards each other not separated by a center stile.)

Oven Cabinets

OC3384B	2610
OC3390B	2816
OC3396B	3004
OM3384B	2462
OM3390B	2656
OM3396B	2834

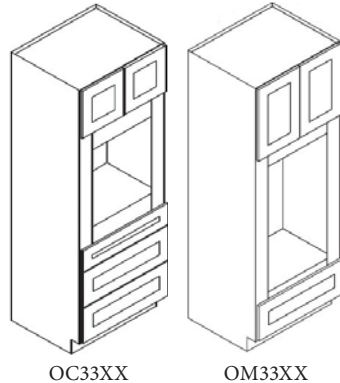

Wall Pantries

WP1584	1406
WP1590	1513
WP1596	1616
WP1884	1576
WP1890	1693
WP1896	1810
WP2484B	1974
WP2490B	2123
WP2496B	2273

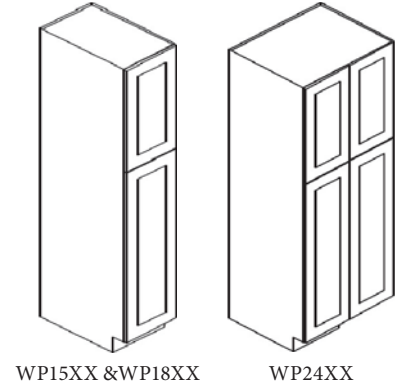

Decor Doors and Panels

End Decorative Doors

EPW1230D	174
EPW1236D	212
EPW1242D	253
EPB24D	438
EPWP2484(2)	541
EPWP2490(2)	610
EPWP2496(2)	669

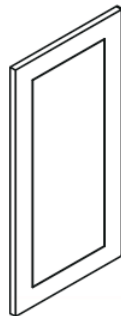

Dishwasher End Panel

DWR33412	182
----------	-----

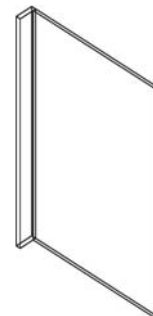

Titanium Pricing

Decor Doors and Panels

Finished Back Panels and Bead Board

FBP483614(1)	216
FBP369614(1)	364
FBP489614(1)	384
BP48341214	362

- Finished Back Panel and Bead Board finished on one side
- BP = 1/4" thick bead board panel

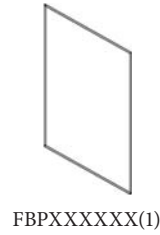

Refrigerator End Panels

REP2484-3/4"	475
REP2496-3/4"	541
REP2484(3)-3/4"	549
REP2496(3)-3/4"	654
REP3096(3)-3/4"	889

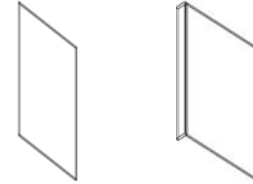

- (3) = 3" Return
- REP24XX and REP24XX(3) have 2 finished edges usable without 3" return
- REP3096(3)-3/4 has 1 finished edge usable with or without 3" return

Pull Outs

Trash Can Pull Out

TCR21-2	679
---------	-----

TCR21-2 Fits B18 or B21 Sold Separately

- Full Extension, not soft closing
- Includes 2 plastic cans approx 29qt capacity

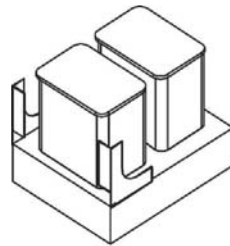

Roll Out Trays

15RT-DR	178
18RT-DR	200
24RT-DR	218
27RT-DR	240
30RT-DR	263
33RT-DR	319
36RT-DR	376

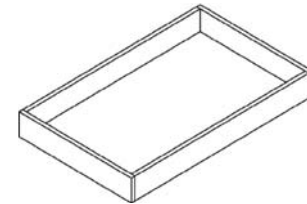

Fillers, Trim, Moldings, Legs, Corbels and Appliques

Valances

VAL48B	257
VAL54B	279

Available in TG and TQ

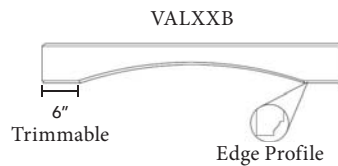

Light Rail Moldings

LRM8	184
TLRM8	448

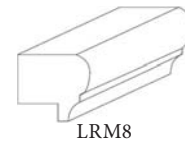

VAL48S	257
VAL54S	279

Available in AN

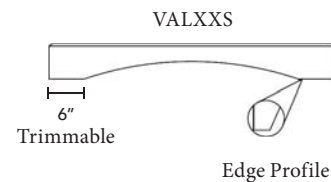

VAD3612	263
VAD4212	331
VAD4812	416

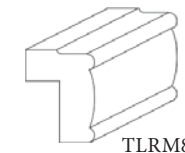
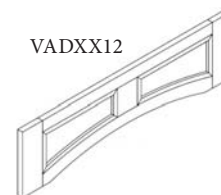

Corner Moldings

SC1-3 (SM)	46
SC4 (ICM)	67
SC5 (OCM)	65
SC6 (SM)	75
SC8 (BM)	71

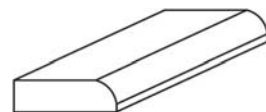

SC1-3 Bull Nose Scribe Molding

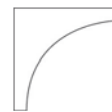

SC4 Inside Corner Molding

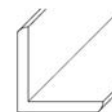

SC5 Outside Corner Molding



SC6 Shoe Molding

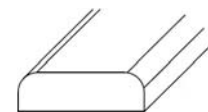

SC8 Batten Molding

Fillers, Trim, Moldings, Legs, Corbels and Appliques

Crown Moldings

CM96	168
CM96-4 ¹	273
CM96H-4	271
CM96K-4 ²	317

1. Available in TQ only
2. Not available in TQ

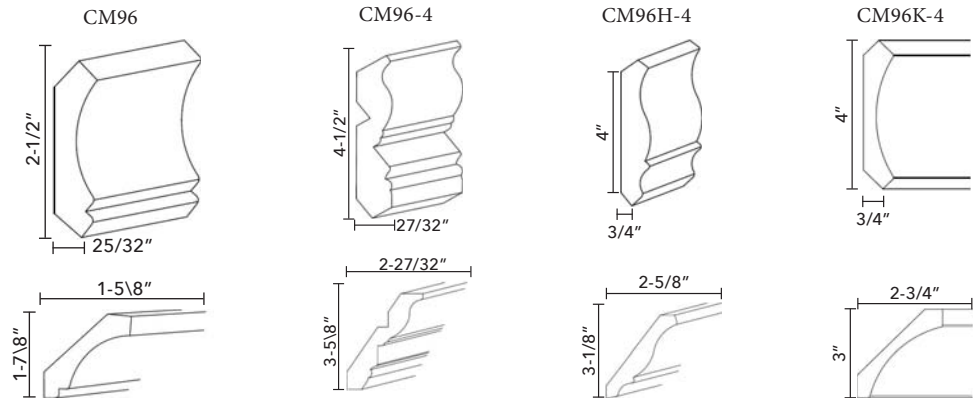

Toe Kick

TK8	111
-----	-----



Range Hood

AWH36	1159
CWH36	1380

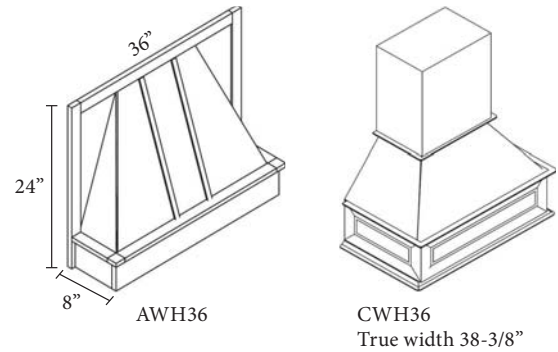

Corbels & Appliques

CORBEL56 ¹	291
CORBEL57 ¹	452
CORBEL59	216
CORBEL60S	364
CORBEL75S	362
CORBEL75M	493
CORBEL75L	521



Base Board Molding

BM4-1/2"-5/8"	263
---------------	-----



Titanium Pricing

Fillers, Trim, Moldings, Legs, Range Hood, Corbels and Appliques

Wall and Base Fillers

WF3-3/4	51
WF336-3/4	63
WF342-3/4	79
WF384-3/4	143
WF396-3/4	168
WF6-3/4	103
WF642-3/4	149
WF696-3/4	329
BF3-3/4	83
BF6-3/4	139
A30WF ¹	83
A36WF ¹	103
A42WF ¹	117
A3BF ¹	113
A6BF ¹	234
CLB334-1/2	386
CLW330	250
CLW336	297
CLW342	347
CLW396	1155

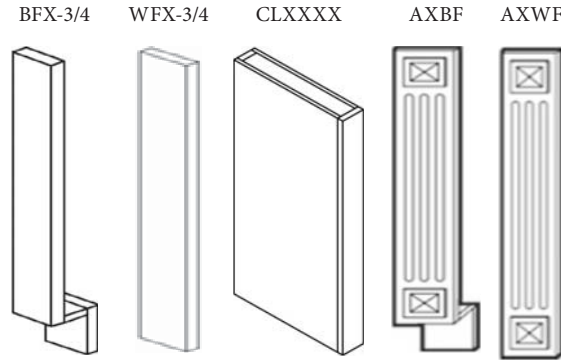

Boxed columns
can be used as
floating shelves

Overlay Fillers

OLF330	51
OLF336	63
OLF342	79
OLF630	93
OLF636	123
OLF642	137
OLF384	216
OLF390	257
OLF396	293

- 3/4" Solid Wood
- Outer Profile Matches Door Color
- Mounted to Wall Filler, Base Filler or Column Boxes. Filler Sold Separately

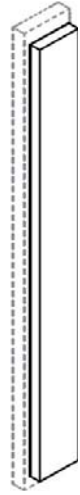

Decor Legs

TP3/WF34-1/2" ¹	475
LEG28 B3x3 ¹	566
LEG75 B3x3	566
LEG81 ¹	400
POLE28-B3 ¹	519
POLE28-W330 ¹	289
POLE28-W336 ¹	319
POLE28-W342 ²	366
POLE75-B3	515
POLE75-W330	287
POLE75-W336	315
POLE75-W342	364
POLE75-T384	622
POLE75-T390	659
POLE75-T396	697

1. Available in TQ only
2. Available in TG and TQ

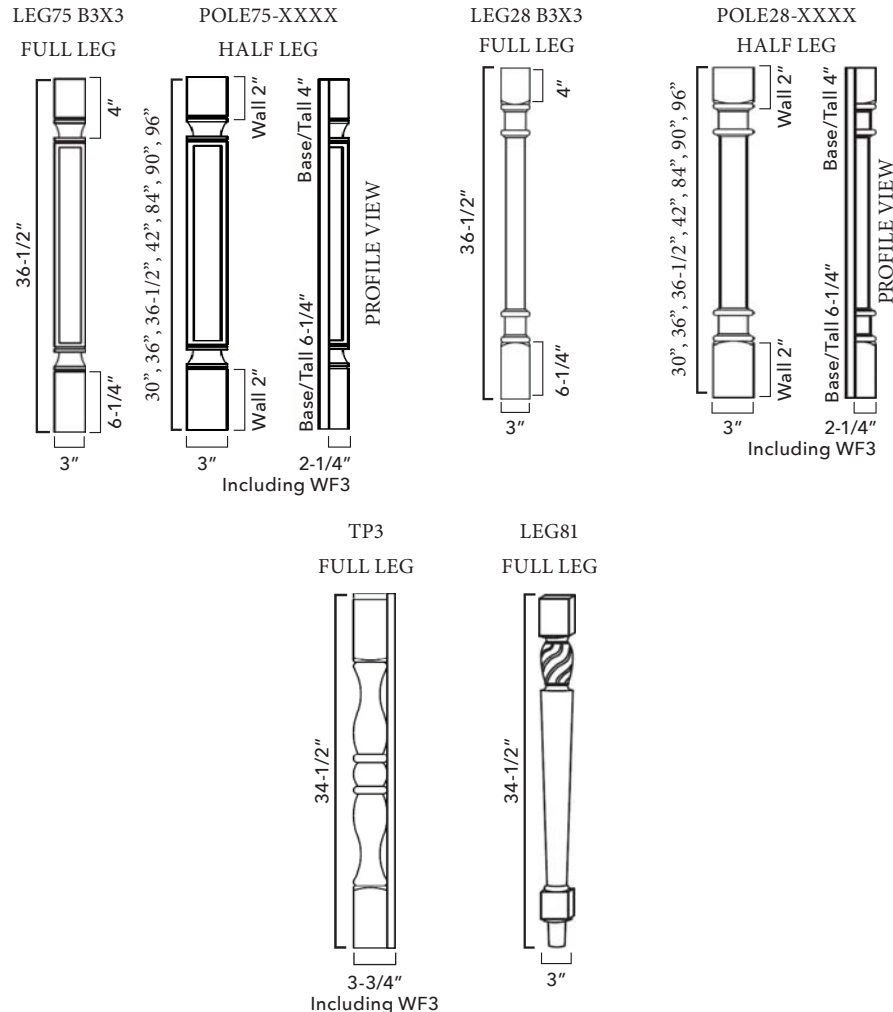

Vanities

24"W -36"W = 2 Butt Doors (2 doors that open towards each other not separated by a center stile.)

Vanities with Drawers

S3021DL-34-1/2"	1012
S3021DR-34-1/2"	1012
S3621BDL-34-1/2"	1159
S3621BDR-34-1/2"	1159
S4821B12D-34-1/2"	1582

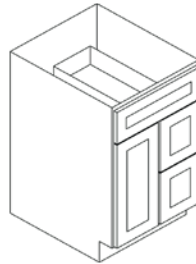

S3021DR

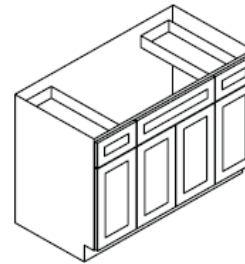

S4821B

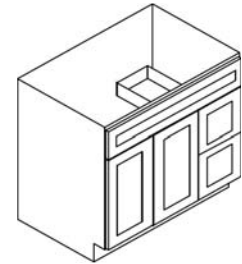

S3621BDR

Vanities without Drawers

S2421B-34-1/2"	566
S3021B-34-1/2"	713
S3621B-34-1/2"	861

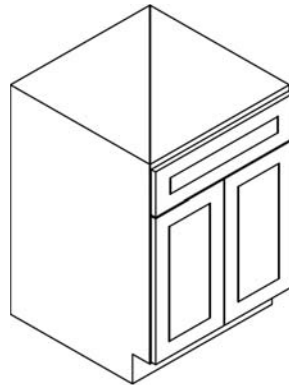

Vanity Drawer Bases

SVB1221-34-1/2"	1079
SVB1521-34-1/2"	1127
SVB1821-34-1/2"	1370

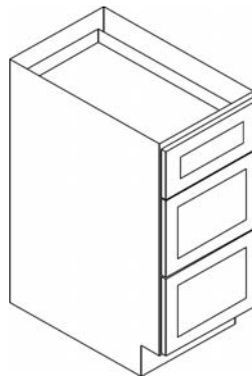

Wall Cabinet-2 Built in Drawers

Not available in MR

W2D1848	852
W2D1854	994
W2D1860	1135

- Drawers are not soft-closing
- Glass Doors are available for this unit W18XXGD
- Listed in Wall Cabinet Section in both the order form and on the Online ordering

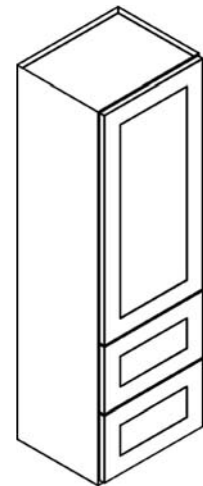

Desk Drawer (Makeup Drawer)

SVDU3021-7"	309
-------------	-----

SVDU = Desk Drawer 30"W x 7"H x 20"D

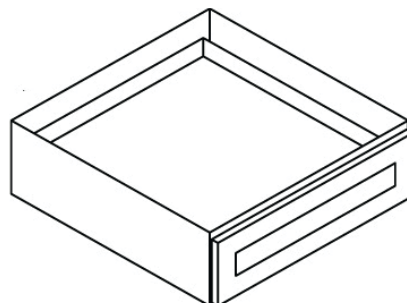





Glass Doors Sold Separately

All glass doors include glass preinserted.

When ordering a glass door first order the wall cabinet that the glass door(s) will be inserted. You will receive the wall cabinet with the original door(s) and the glass doors will come separately. When assembling, simply take the original doors or the hinges and replace with the glass door(s).



Silver Line

Glass Doors With Mullion

Linen Glass (see-through frosted)

W3030BMGD	333
WDC2430MGD	176
W3036BMGD	378
WDC2436MGD	210
W3042BMGD	467
WDC2442MGD	246



Gold Line

Glass Doors No Mullion

AW - Clear Glass AP - Frosted Glass

30" Wall		36" Wall		42" Wall	
W1530GD	164	W1536GD	194	W1542GD	228
W1830GD	216	W1836GD	259	W1842GD	301
W2430BGD ¹	275	W2436BGD ¹	319	W2442BGD ¹	384
W3030BGD	333	W3036BGD	378	W3042BGD	467
W3630BGD	491	W3636BGD	527	W3642BGD	652
WDC2430GD	176	WDC2436GD	210	WDC2442GD	246
		WDC273615GD	248	WDC274215GD	303



1. Not available in AP

Bridge Glass Door Not available in AP

12" Wall	
W3012BGD	327
W1512GD	190
W1812GD	234
W2412BGD	323

Platinum Line

Glass Doors No Mullion AB, AG, AX, TS, TW

Clear Glass

30" Wall		36" Wall		42" Wall	
W1530GD	164	W1536GD	194	W1542GD	228
W1830GD	216	W1836GD	259	W1842GD	301
W2430BGD ¹	287	W2436BGD ¹	331	W2442BGD ¹	402
W3030BGD	333	W3036BGD	378	W3042BGD	467
W3630BGD	491	W3636BGD	527	W3642BGD	652
WDC2430GD	176	WDC2436GD	210	WDC2442GD	246
		WDC273615GD	248	WDC274215GD	303



1. Available in AG only

Bridge Glass Door

Clear Glass

12" Wall	
W3012BGD	327

Available in AB,AG,AX, TS,TW only

Bridge Glass Door Clear Glass

*Available in AG and TW Only

12" Wall	
W1512GD***	194
W1812GD***	242
W2412BGD***	335

Glass Doors With Mullion GW, SL, TS, TW Clear Glass

30" Wall	GW, SL	TS, TW	36" Wall	GW, SL	TS, TW	42" Wall	GW, SL	TS, TW
W1530MGD	164	180	W1536MGD	194	214	W1542MGD	228	250
W1830MGD	216	238	W1836MGD	259	285	W1842MGD	301	331
W2430BMGD	287	287	W2436BMGD	331	331	W2442BMGD	402	402
W3030BMGD	333	368	W3036BMGD	378	416	W3042BMGD	467	515
W3630BMGD ¹	491	491	W3636BMGD ¹	527	527	W3642BMGD ¹	652	652
WDC2430MGD	176	194	WDC2436MGD	210	230	WDC2442MGD	246	271
			WDC273615MGD	248	275	WDC274215MGD	303	333



1. Not available in TW

Titanium Line

Glass Doors No Mullion

Clear Glass

30" Wall		36" Wall		42" Wall	
W1530GD	184	W1536GD	218	W1542GD	257
W1830GD	242	W1836GD	291	W1842GD	337
W2430BGD ¹	309	W2436BGD ¹	358	W2442BGD ¹	430
W3030BGD	374	W3036BGD	424	W3042BGD	523
W3630BGD	551	W3636BGD	592	W3642BGD	731
WDC2430GD	198	WDC2436GD	236	WDC2442GD	277
		WDC273615GD	279	WDC274215GD	339



1. Only available in AN

Bridge Glass Door Not available in TG

Clear Glass

12" Wall	
W3012BGD	368

Glass Doors With Mullion

Clear Glass

30" Wall		36" Wall		42" Wall	
W1530MGD	202	W1536MGD	240	W1542MGD	281
W1830MGD	269	W1836MGD	319	W1842MGD	372
W2430BMGD ¹	339	W2436BMGD ¹	386	W2442BMGD ¹	461
W3030BMGD	412	W3036BMGD	467	W3042BMGD	576
W3630BMGD ²	608	W3636BMGD ²	652	W3642BMGD ²	806
WDC2430MGD	218	WDC2436MGD	259	WDC2442MGD	305
		WDC273615MGD	309	WDC274215MGD	374



1. Not available in AN
2. Not available in TQ

Glides Soft Closing Drawer Tracks

	Net Cost	For Use In	Actual Size
S50-09	22	9"W x 24" D Base	22-1/2"
S50-15	22	15" D Base	12-1/2"
S50-18	22	18" D Base	15-1/2"
S50-21	22	21" D Base	18-1/2"
S50-24	22	24" D Base	22-1/2"

K-Series Glides Soft Closing Door Tracks

	Net Cost	For Use In	Actual Size
J20-9	22	9"W x 24" D Base	21-1/2"
J20-18	22	18" D Base	15-1/2"
J20-21	22	21" D Base	18-1/2"
J20-24	22	24" D Base	22-1/2"

Hinges

	Net Cost
Soft Close Hinge	3
Soft Close Hinge-WDC	3
Soft Close Hinge-BDC36	8
LS Hinge - Door to Door (WSQ)	8
LS Hinge - Door to Frame (WSQ)	8

Repair Kits, Paints and Stains

	Net Cost
Repair Kit	14
Stain / Spray Paint	26

Bumpers

	Net Cost
Bumpers (Pack of 20)	6

Carry Bag

	Net Cost
Forevermark Sample Bag	120



Sample Doors

	Net Cost
Sink Front Mini Sample (Door Sample)	30



KC KE KM AW AP SL GW AX



TW AB AG TS TG AN TQ





Specification Sheets



Wall Cabinets B = Butt doors. Two doors that open towards each other not separated by a center stile.

Item#	Width	Height	Depth	Door	Drawer	Shelf
W0930	9"	30"	12"	1	0	2
W1230	12"	30"	12"	1	0	2
W1530	15"	30"	12"	1	0	2
W1830	18"	30"	12"	1	0	2
W2130	21"	30"	12"	1	0	2
W2430B	24"	30"	12"	2	0	2
W2730B	27"	30"	12"	2	0	2
W3030B	30"	30"	12"	2	0	2
W3330B	33"	30"	12"	2	0	2
W3630B	36"	30"	12"	2	0	2
W0936	9"	36"	12"	1	0	2
W1236	12"	36"	12"	1	0	2
W1536	15"	36"	12"	1	0	2
W1836	18"	36"	12"	1	0	2
W2136	21"	36"	12"	1	0	2
W2436B	24"	36"	12"	2	0	2
W2736B	27"	36"	12"	2	0	2
W3036B	30"	36"	12"	2	0	2
W3336B	33"	36"	12"	2	0	2
W3636B	36"	36"	12"	2	0	2
W0942	9"	42"	12"	1	0	3
W1242	12"	42"	12"	1	0	3
W1542	15"	42"	12"	1	0	3
W1842	18"	42"	12"	1	0	3
W2142	21"	42"	12"	1	0	3
W2442B	24"	42"	12"	2	0	3
W2742B	27"	42"	12"	2	0	3
W3042B	30"	42"	12"	2	0	3
W3342B	33"	42"	12"	2	0	3
W3642B	36"	42"	12"	2	0	3

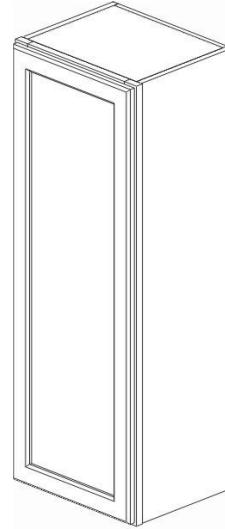

Widths of 9, 12, 15, 18, 21

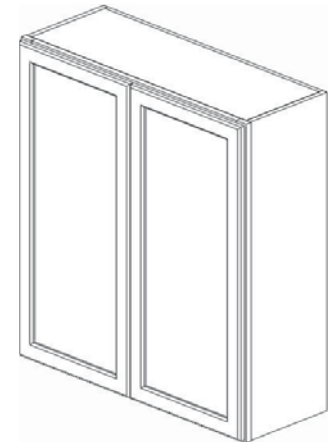

Widths of 24, 27, 30, 33, 36

Bridge Cabinets B = Butt doors. Two doors that open towards each other not separated by a center stile.

Item#	Width	Height	Depth	Door	Drawer	Shelf
W3012B	30"	12"	12"	2	0	0
W3312B	33"	12"	12"	2	0	0
W3612B	36"	12"	12"	2	0	0
W361224B	36"	12"	24"	2	0	0
W2415B	24"	15"	12"	2	0	0
W3015B	30"	15"	12"	2	0	0
W301524B	30"	15"	24"	2	0	0
W3315B	33"	15"	12"	2	0	0
W331524B	33"	15"	24"	2	0	0
W3615B	36"	15"	12"	2	0	0
W361524B	36"	15"	24"	2	0	0
W2418B	24"	18"	12"	2	0	0
W3018B	30"	18"	12"	2	0	0
W301824B	30"	18"	24"	2	0	0

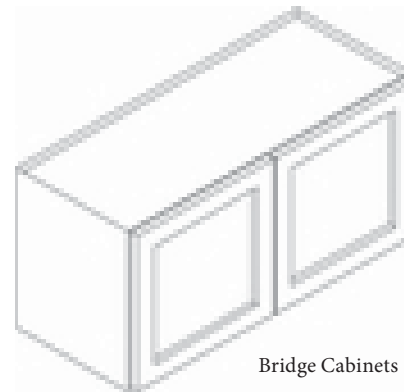

Bridge Cabinets

Bridge Cabinets Continued

Item#	Width	Height	Depth	Door	Drawer	Shelf
W3318B	33"	18"	12"	2	0	0
W331824B	33"	18"	24"	2	0	0
W3618B	36"	18"	12"	2	0	0
W361824B	36"	18"	24"	2	0	0
W2424B	24"	24"	12"	2	0	1
W3024B	30"	24"	12"	2	0	1
W302424B	30"	24"	24"	2	0	1
W3324B	33"	24"	12"	2	0	1
W332424B	33"	24"	24"	2	0	1
W3624B	36"	24"	12"	2	0	1
W362424B	36"	24"	24"	2	0	1

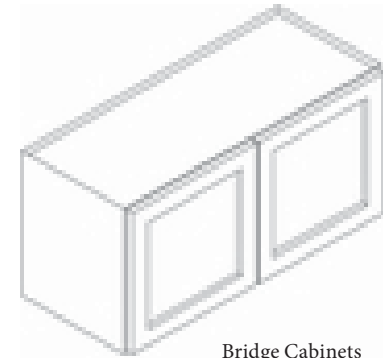

Bridge Cabinets

Wall Diagonal Corner Cabinets

Item#	Width	Height	Depth	Door	Drawer	Shelf
WDC2430	24"	30"	12"	1	0	2
WDC2436	24"	36"	12"	1	0	2
WDC2442	24"	42"	12"	1	0	3
WDC273615	27"	36"	15"	1	0	2
WDC274215	27"	42"	15"	1	0	3

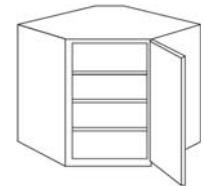

WDCXXXX

Wall Corner Cabinet

Item#	Width	Height	Depth	Door	Drawer	Shelf
WSQ2430	24"	30"	12"	Bi-Fold	0	2
WSQ2436	24"	36"	12"	Bi-Fold	0	2
WSQ2442	24"	42"	12"	Bi-Fold	0	3

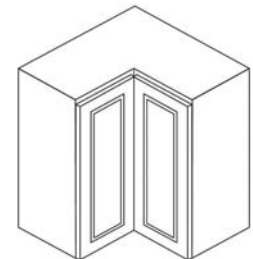

WSQ24XX

Wall Cabinet - With 2 Built-In Drawers Drawers are not soft closing

Item#	Width	Height	Depth	Door	Drawer	Shelf
W2D1848	18"	48"	12"	1	2	2
W2D1854	18"	54"	12"	1	2	2
W2D1860	18"	60"	12"	1	2	3

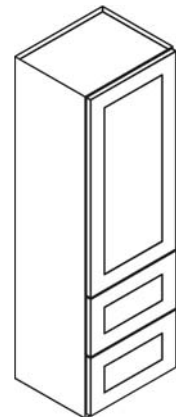

W2D18XX

Wine Rack

Item#	Width	Height	Depth
W3018WR	30	18	12

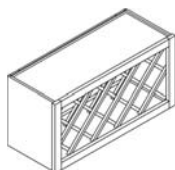

W3018WR

Microwave Oven

Item#	Width	Height	Depth
MWO3018PM-12	30"	18"	12"

Stationary Shelf is 18" Deep. Opening = 26-7/8"W x 14-1/8"H

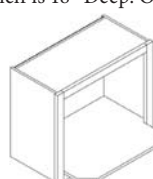

MWO3018PM-12

Spec Sheets Wall Cabinets

Angle Wall (Door Width is 16-7/16")

Item#	Width	Height	Depth	Door	Drawer	Shelf
AW30	12"	30"	12"	1	0	2
AW36	12"	36"	12"	1	0	2
AW42	12"	42"	12"	1	0	3



AWXX

Wall End Shelf - With Open Shelves

Item#	Width	Height	Depth	Door	Drawer	Shelf
WES530	5"	30"	11-1/2"	0	0	2
WES536	5"	36"	11-1/2"	0	0	2
WES542	5"	42"	11-1/2"	0	0	3

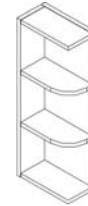

WES5XX

Wall Cubes

Item#	Width	Height	Depth	Cubes
WC630	6"	30"	12"	5 cubes
WC636	6"	36"	12"	6 cubes
WC642	6"	42"	12"	7 cubes

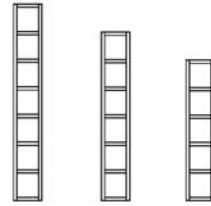

WC6XX

Spec Sheets Base Cabinets

Sink Bases B = Butt doors. Two doors that open towards each other not separated by a center stile.

Item#	Width	Height	Depth	Door	Drawer	Shelf
SB24B	24"	34-1/2"	24"	2	0	0
SB27B	27"	34-1/2"	24"	2	0	0
SB30B	30"	34-1/2"	24"	2	0	0
SB33B	33"	34-1/2"	24"	2	0	0
SB36B	36"	34-1/2"	24"	2	0	0
SB42B	42"	34-1/2"	24"	2	0	0
SB60B	60"	34-1/2"	24"	4	2	0

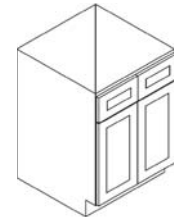
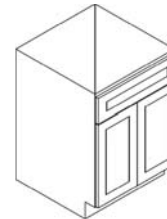

SB24B, SB27B and SB30B

SB33B, SB36B and SB42B

Farm Sink Base B = Butt doors. Two doors that open towards each other not separated by a center stile.

Item#	Width	Height	Depth	Door	Drawer	Shelf
FSB30B	30"	34-1/2"	24"	2	0	0
FSB33B	33"	34-1/2"	24"	2	0	0
FSB36B	36"	34-1/2"	24"	2	0	0

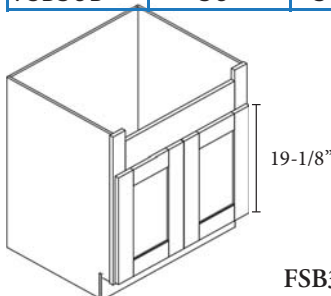

19-1/8"

FSB30B, FSB33B, FSB36B
Fits most farm sinks

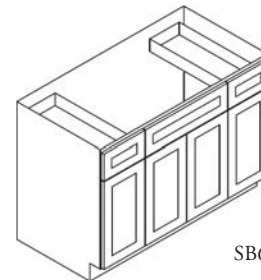
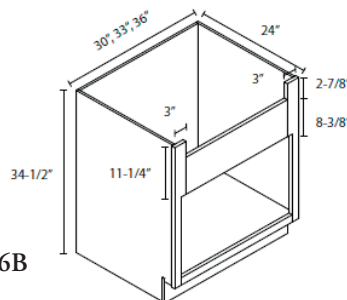

SB60B

Spec Sheets Base Cabinets

Base Diagonal Corner Sink

Item#	Width	Height	Depth	Door	Drawer	Shelf
BDCF36	36"	34-1/2"	24"	1	0	1
BDCF36K-FL	36"	34-1/2"	24"	1	0	0

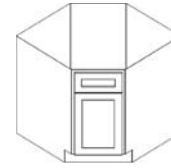

BDCF36

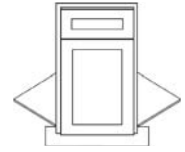

BDCF36K-FL

Base Cabinets B = Butt doors. Two doors that open towards each other not separated by a center stile.

Item#	Width	Height	Depth	Door	Drawer	Shelf
B09*	9"	34-1/2"	24"	1	1	1
B12	12"	34-1/2"	24"	1	1	1
B15	15"	34-1/2"	24"	1	1	1
B18	18"	34-1/2"	24"	1	1	1
B21	21"	34-1/2"	24"	1	1	1
B24B	24"	34-1/2"	24"	2	1	1
B27B	27"	34-1/2"	24"	2	1	1
B30B	30"	34-1/2"	24"	2	1	1
B33B	33"	34-1/2"	24"	2	2	1
B36B	36"	34-1/2"	24"	2	2	1

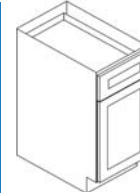

B09-B21

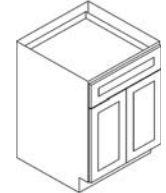

B24B-B30B

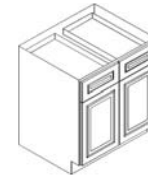

B33B and B36B

*B09 Cabinets do not come with triggers to connect with the drawer slides.

Drawer Bases

Item#	Width	Height	Depth	Door	Drawer	Shelf
DB12(3)	12"	34-1/2"	24"	0	3	0
DB15(3)	15"	34-1/2"	24"	0	3	0
DB18(3)	18"	34-1/2"	24"	0	3	0
DB21(3)	21"	34-1/2"	24"	0	3	0
DB24(3)	24"	34-1/2"	24"	0	3	0
DB30(3)	30"	34-1/2"	24"	0	3	0
DB36(3)	36"	34-1/2"	24"	0	3	0

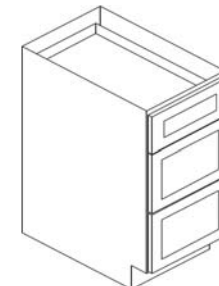

DBXX(3)

Lazy Susan Cabinets and EZ Reach Cabinet Bi-fold doors not soft closing

Item#	Width	Height	Depth	Door	Drawer	Shelf/Tray
LS3309	33"	34-1/2"	33"	Bi-Fold	0	Tray
LS3612	36"	34-1/2"	36"	Bi-Fold	0	Tray
LS3612S (EZ3612)	36"	34-1/2"	36"	Bi-Fold	0	Shelf

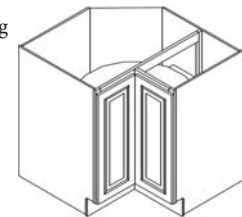

LSXXXX and LS3612S

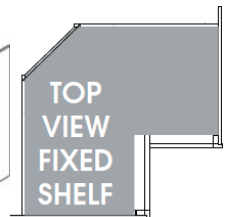

Base - Pull Out With Spice Rack

Side mount full extension drawer track, not soft closing.
Unit is pre-assembled. Includes cabinet and spice rack insert.
Two middle racks are adjustable.

Item#	Width	Height	Depth	Door
BFP09	9"	34-1/2"	24"	1

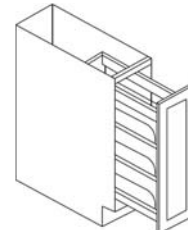

BFP09

Microwave Base Cabinet

Opening: 26-7/8"W x 18"H
Drawer front size is 29-1/2"W x 8-13/16"H

Item#	Width	Height	Depth	Drawers
B30MW/(30"W)	30"	34-1/2"	24"	1

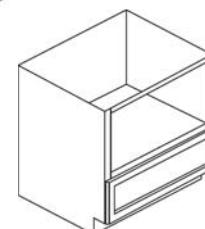

B30MW/(30"W)

Base Blind Corner Cabinets

Item#	Width	Height	Depth	Door	Drawer	Shelf
BBLC39/42-36"W	36"	34-1/2"	24"	1	1	1
BBLC42/45-39"W	39"	34-1/2"	24"	1	1	1
BBLC45/48-42"W	42"	34-1/2"	24"	1	1	1

BBLC39/42-36"W

Min Pull	39"W
Max Pull	42"W
Dimension	Measurements
A	36"
B	11-3/4"
C	11-9/16"
D	8-7/8"
E	24-1/4"
F	13-3/4"

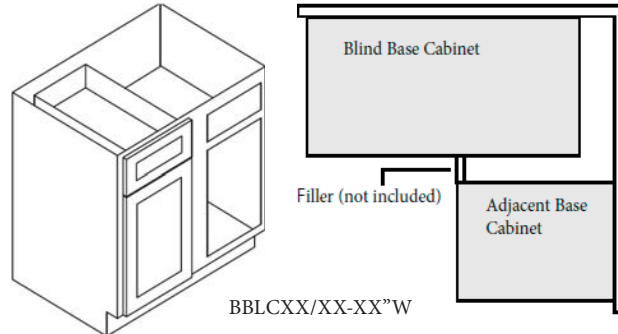

BBLC42/45-39"W

Min Pull	42"W
Max Pull	45"W
Dimension	Measurements
A	39"
B	14-3/4"
C	14-9/16"
D	11-7/8"
E	24-1/4"
F	10-3/4"

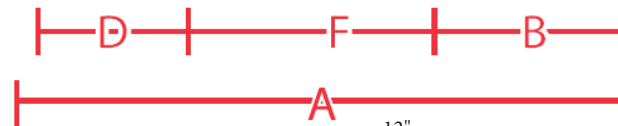
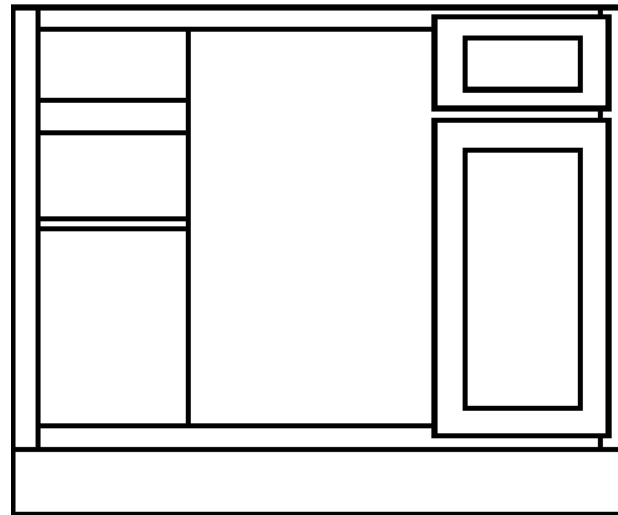

BBLC45/48-42"W

Min Pull	45"
Max Pull	48"
Dimension	Measurements
A	42"
B	17-3/4"
C	17-1/2"
D	14-7/8"
E	24-1/4"
F	7-3/4"

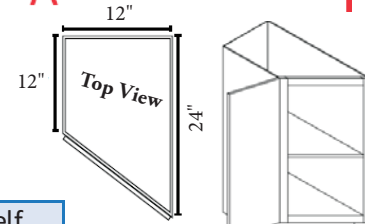

BTC12X

Base Transitional Cabinet Door Size 16-1/2"

Item#	Width	Height	Depth	Door	Drawer	Shelf
BTC12R	12"	34-1/2"	24" to 12"	1	0	1
BTC12L	12"	34-1/2"	12" to 24"	1	0	1

Angle Base Door Size 17-7/8". Both doors are functional.

Item#	Width	Height	Depth	Door	Drawer	Shelf
AB24 (Base)	24"	34-1/2"	24"	2	0	1

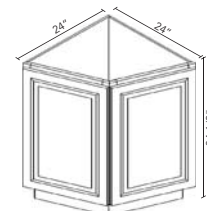

AB24(Base)

Specs Sheets Tall Cabinets

Wall Pantries

Upper door height same as wall cabinets. 30"(84"), 36"(90"), 42"(96"). Bottom door 47-3/4"

Item#	Width	Height	Depth	Door	Drawer	Fixed Shelf	Adj Shelf
WP1584	15"	84"	24"	2	0	1	3
WP1590	15"	90"	24"	2	0	1	5
WP1596	15"	96"	24"	2	0	1	6
WP1884	18"	84"	24"	2	0	1	3
WP1890	18"	90"	24"	2	0	1	5
WP1896	18"	96"	24"	2	0	1	6
WP2484B	24"	84"	24"	4	0	1	3
WP2490B	24"	90"	24"	4	0	1	5
WP2496B	24"	96"	24"	4	0	1	6

Item#	Door Width	Top Door Height	Bottom Door Height
WP1584	14-1/2"	29-5/16"	49-1/4"
WP1590	14-1/2"	35-5/16"	49-1/4"
WP1596	14-1/2"	41-5/16"	49-1/4"
WP1884	17-9/16"	29-5/16"	49-1/4"
WP1890	17-9/16"	35-5/16"	49-1/4"
WP1896	17-9/16"	41-5/16"	49-1/4"
WP2484B	11-11/16"	29-5/16"	49-1/4"
WP2490B	11-11/16"	35-5/16"	49-1/4"
WP2496B	11-11/16"	41-5/16"	49-1/4"

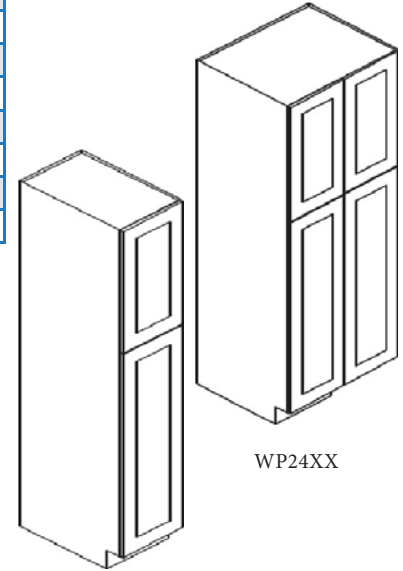

WP15XX & WP18XX

WP24XX

Oven Cabinets

Item#	Width	Height	Depth	Door	Drawer	Shelf
OC3384B	33"	84"	24"	2	3	0
OC3390B	33"	90"	24"	2	3	0
OC3396B	33"	96"	24"	2	3	1
OM3384B	33"	84"	24"	2	1	0
OM3390B	33"	90"	24"	2	1	0
OM3396B	33"	96"	24"	2	1	1

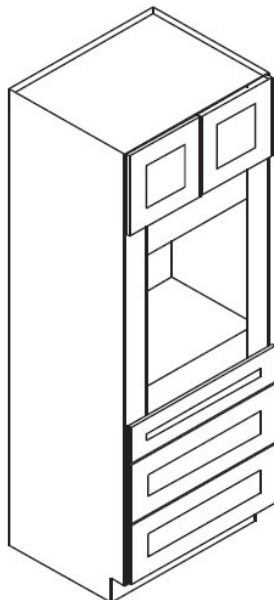

OC33XXB

Oven Cabinet Opening Sizes

Item #	Openings	Door Height	Door Width
OC3384B	24"W x 24"H	20-5/16"	16-1/4"
OC3390B	24"W x 24"H	23-5/16"	16-1/4"
OC3396B	24"W x 24"H	29-5/19"	16-1/4"
OM3384B	24"W x 42"H	14-1/4"	16-1/4"
OM3390B	24"W x 42"H	17-1/4"	16-1/4"
OM3396B	24"W x 42"H	23-1/4"	16-1/4"

Oven Cabinet Drawer Sizes

Item#	Top Drawer Height	2nd & 3rd Drawer Height	Door Width
OC33XXB	6-1/4"	11-1/16"	32-1/2"

Item#	Drawer Height	Drawer Width
OM33XXB	11-1/4"	32-1/2"

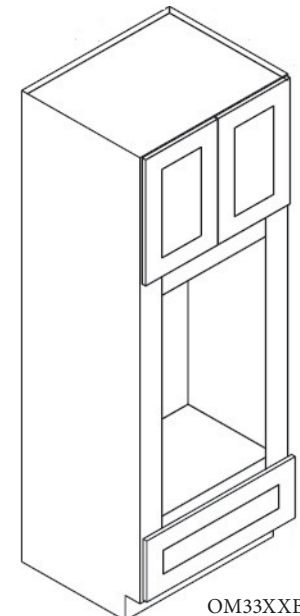

OM33XXB

Spec Sheets Decor Doors and Panels

Dishwasher Panels With 3" Return. Edge not finished without 3" return.

Item#	Width	Height	Thickness	Description
DWR33412	24"	34-1/2"	1/2"	1 Side Finish, 3" return (not attached)



DWR33412, REP24XX(3)-3/4",
REP3096(3)-3/4"

Refrigerator End Panels

Item#	Width	Height	Thickness	Description
REP2484-3/4"	24"	84"	3/4"	2 Sides Finish (Banded Edge)
REP2496-3/4"	24"	96"	3/4"	2 Sides Finish (Banded Edge)
REP2484(3)-3/4"	24"	84"	3/4"	2 Sides Finish, 3" return (not attached)
REP2496(3)-3/4"	24"	96"	3/4"	2 Sides Finish, 3" return (not attached)
REP3096(3)-3/4"	30"	96"	3/4"	1 Sides Finish, 3" return (not attached)



REP24XX-3/4, FBPXXXX14(1)

REP24XX-3/4", REP24XX-3/4"(3) have 2 finished edges, usable with or without 3" Return.
REP3096(3)-3/4" has 1 finished edge, usable with or without 3" return.

Finished Back Panels and Beaded Board

FBP483614(1)	36"	48"	1/4"	1 Side Finish (Vertical Grain)
FBP369614(1)	96"	36"	1/4"	1 Side Finish (Vertical Grain)
FBP489614(1)	96"	48"	1/4"	1 Side Finish (Vertical Grain)
BP48341214	48"	34-1/2"	1/4"	1 Side Finish

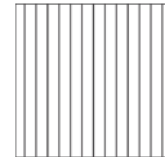

BP48341214

End Decorative Doors

Item#	Width	Height
EPW1230D	11-1/2"	29-5/16"
EPW1236D	11-1/2"	35-5/16"
EPW1242D	11-1/2"	41-5/16"
EPB24D	23-3/4"	29-5/16"



EPXXD

Lattice Doors

Item#	Width	Height
SB30B-ND-SP	14-3/4"	22-7/8"
SB33B-ND-SP	16-1/4"	22-7/8"
SB36B-ND-SP	17-3/4"	22-7/8"

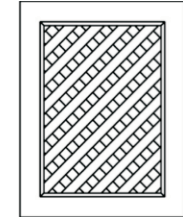

SBXXB-ND-SP

			Middle/Bottom	Middle/Bottom
	Top Door	Top Door	Door	Door
Item#	Width	Height	Width	Height
EPWP2484D	23-3/4"	29-5/16"	23-3/4"	49-1/4"
EPWP2490D	23-3/4"	35-5/16"	23-3/4"	49-1/4"
EPWP2496D	23-3/4"	41-5/16"	23-3/4"	49-1/4"

Pull Outs

Trash Can Pull Out

Item#	Width	Height	Depth	Cabinet Fits
TCR21-2	16 5/8"	16 5/16"	21"	Fits B18 or B21

Full extension, not soft closing.
Includes 2 plastic cans, approx
29qt capacity.

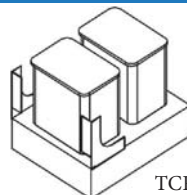

TCR21-2

Roll Out Trays

Item#	Width	Height	Depth
15RT-DR	11"	2-7/8"	21"
18RT-DR	14"	2-7/8"	21"
24RT-DR	20"	2-7/8"	21"
27RT-DR	23"	2-7/8"	21"
30RT-DR	26"	2-7/8"	21"
33RT-DR	29"	2-7/8"	21"
36RT-DR	32"	2-7/8"	21"

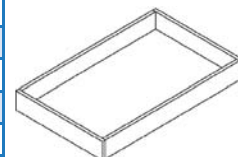

XXRT-DR

Spec Sheet Glass Doors and Range Hoods

Glass Doors

Item#	Width	Height
W3012BGD (2pc)	14-11/16"	11-5/16"
W1530GD (1pc)	14-1/2"	29-5/16"
W1530MGD (1pc)	14-1/2"	29-5/16"
W1830GD (1pc)	17-1/2"	29-5/16"
W1830MGD (1pc)	17-1/2"	29-5/16"
W2430BGD (2PC)	11-3/4"	29-5/16"
W2430BMGD (2PC)	11-3/4"	29-5/16"
W3030BGD (2pcs/set)	14-11/16"	29-5/16"
W3030BMGD (2pcs/set)	14-11/16"	29-5/16"
W3630BGD (2pcs/set)	17-11/16"	29-5/16"
W3630BMGD (2pcs/set)	17-11/16"	29-5/16"
WDC2430GD (1pc)	14-15/16"	29-5/16"
WDC2430MGD (1pc)	14-15/16"	29-5/16"
W1536GD (1pc)	14-1/2"	35-5/16"
W1536MGD (1pc)	14-1/2"	35-5/16"
W1836GD (1pc)	17-1/2"	35-5/16"
W1836MGD (1pc)	17-1/2"	35-5/16"
W2436BGD (2PC)	11-3/4"	35-5/16"
W2436BMGD (2PC)	11-3/4"	35-5/16"
W3036BGD (2pcs/set)	14-11/16"	35-5/16"
W3036BMGD (2pcs/set)	14-11/16"	35-5/16"



No Mullion



With Mullion

Item#	Width	Height
W3636BGD (2pcs/set)	17-11/16"	35-5/16"
W3636BMGD (2pcs/set)	17-11/16"	35-5/16"
WDC2436GD (1pc)	14-15/16"	35-5/16"
WDC2436MGD (1pc)	14-15/16"	35-5/16"
WDC273615GD (1pc)	14-15/16"	35-5/16"
WDC273615MGD (1pc)	14-15/16"	35-5/16"
W1542GD (1pc)	14-1/2"	41-5/16"
W1542MGD (1pc)	14-1/2"	41-5/16"
W1842GD (1pc)	17-1/2"	41-5/16"
W1842MGD (1pc)	17-1/2"	41-5/16"
W2442BGD (2PC)	11-3/4"	41-5/16"
W2442BMGD (2PC)	11-3/4"	41-5/16"
W3042BGD (2pcs/set)	14-11/16"	41-5/16"
W3042BMGD (2pcs/set)	14-11/16"	41-5/16"
W3642BGD (2pcs/set)	17-11/16"	41-5/16"
W3642BMGD (2pcs/set)	17-11/16"	41-5/16"
WDC2442GD (1pc)	14-11/16"	41-5/16"
WDC2442MGD (1pc)	14-11/16"	41-5/16"
WDC274215GD (1pc)	14-11/16"	41-5/16"
WDC274215MGD (1pc)	14-11/16"	41-5/16"

Range Hoods

Range Hoods

Item#	Width	Height	Depth
AWH36	36"	24"	8"
CWH36	38-3/8"	22"+30"	20-1/2"

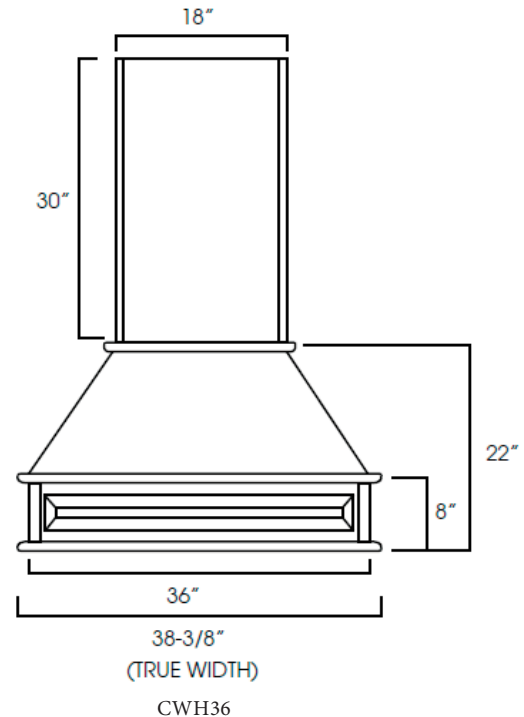
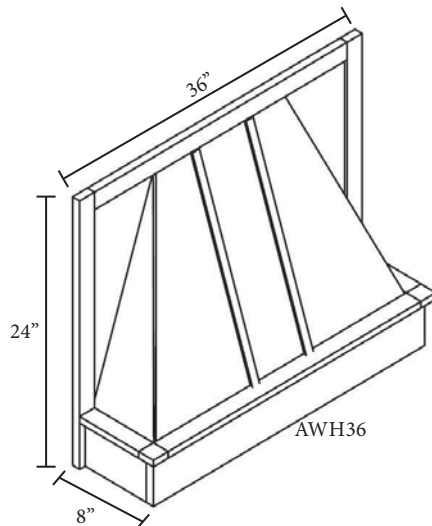

Spec Sheets Valances, Moldings, Corbels and Appliques

Valances

Item#	Width	Height	Details
VAS48	48"	4-5/8"	Trimmable 6" on both sides
VAD3612	36"	12"/8"	Trimmable 2-1/2" on both sides
VAD4212	42"	12"/8"	Trimmable 2-1/2" on both sides
VAD4812	48"	12"/8"	Trimmable 2-1/2" on both sides
VAL48B	48"	6"	Trimmable 6" on both sides
VAL54B	54"	6"	Trimmable 6" on both sides
VAL48S	48"	6"	Trimmable 6" on both sides
VAL54S	54"	6"	Trimmable 6" on both sides

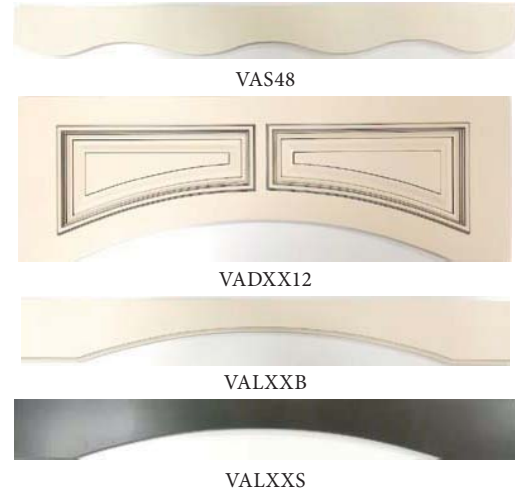

Corner Moldings

Item#	Thickness	Height	Length
SC1-3	1/4"	3/4"	96"
SC4	3/4"	3/4"	96"
SC5	1/4"	3/4"	96"
SC6	1/2"	3/4"	96"
SC8	1/4"	3/4"	96"

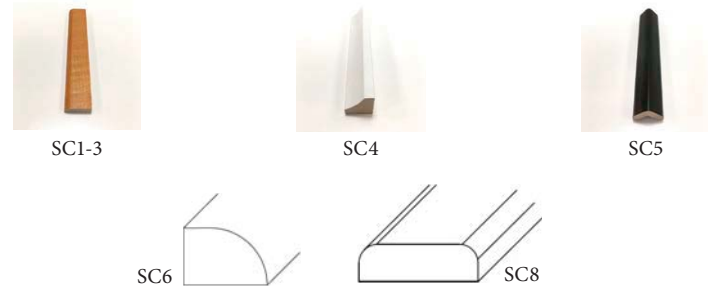

Crown Moldings

Item#	Height	Length	Details
CM96 (Plain)	2-1/2"	96"	
CM96-4 (Plain)	4-1/2"	96"	
CM96B-4 (Egg&Dart)	4-1/2"	96"	Egg & dart attached
CM96C-4 (Rope)	4-1/2"	96"	Rope attached
CM96E-4	2-5/8"	96"	Straight
CM96H-4	4"	96"	Large Cove Detail
CM96K-4 (Coved)	4"	96"	



Corbels & Appliques

Item#	Width	Height	Depth
DOA	19-7/8"	4-1/4"	N/A
CORBEL54	3"	6"	4"
CORBEL55	3"	6"	4"
CORBEL56	3"	6"	4"
CORBEL57	3"	9"	6"
CORBEL58	3"	9"	6"
CORBEL59	3"	9"	6"
CORBEL60S	5"	10"	5"
CORBEL60L	7"	17"	7"
CORBEL75S	3-3/4"	6-1/2"	3-1/2"
CORBEL75M	5-1/4"	12-1/2"	4-1/2"
CORBEL75L	3-1/2"	12-1/2"	8"

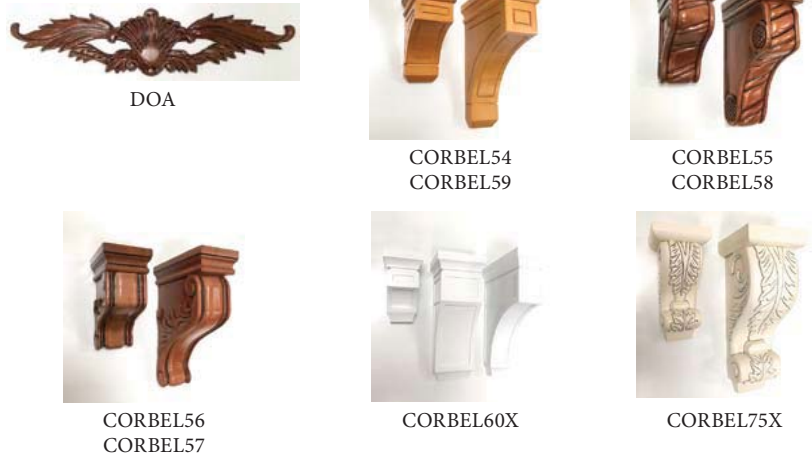

Spec Sheets Fillers, Toe Kick, Moldings, Legs

Light Rail Moldings

Item#	Thickness	Height	Length
LRM8	1-1/2"	1"	96"
TLRM8	1-1/2"	2-1/4"	96"



LRM8



TLRM8

Wall and Base Fillers

Item#	Width	Length	Thickness
WF3-3/4	3"	30"	3/4"
WF336-3/4	3"	36"	3/4"
WF342-3/4	3"	42"	3/4"
WF384-3/4	3"	84"	3/4"
WF396-3/4	3"	96"	3/4"
WF6-3/4	6"	30"	3/4"
WF642-3/4	6"	42"	3/4"
WF696-3/4	6"	96"	3/4"
BF3-3/4	3"	34-1/2"	3/4"
BF6-3/4	6"	34-1/2"	3/4"
A30WF	3"	30"	3/4"
A36WF	3"	36"	3/4"
A42WF	3"	42"	3/4"
A3BF	3"	34-1/2"	3/4"
A6BF	6"	34-1/2"	3/4"



BF3-3/4



WF3-3/4

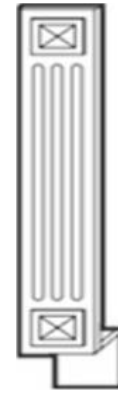

AXBF

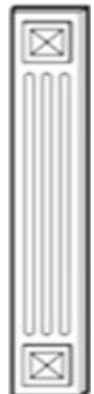

AXWF

Boxed Columns

Item	Thickness	Height	Depth
CLB334-1/2	3"	34-1/2"	24"
CLW330	3"	30"	15"
CLW336	3"	36"	15"
CLW342	3"	42"	15"
CLW396	3"	96"	27"

Trimable to custom heights and depths.

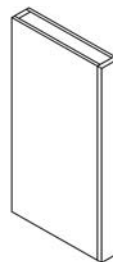

CLXXXX

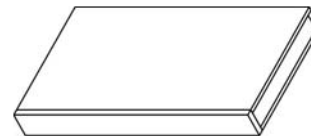

CLXXXX (as a floating shelf)

Toe Kick

Item#	Thickness	Height	Length
TK8	1/4"	4-1/2"	96"

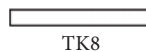

TK8

Base Board Molding

Item#	Thickness	Height	Length
BM4-1/2"-5/8"	5/8"	4-1/2"	96"



BM4-1/2"-5/8"

Overlay Fillers

Item#	Width	Length	Thickness
OLF330	2-1/2"	29-1/4"	3/4"
OLF336	2-1/2"	35-1/4"	3/4"
OLF342	2-1/2"	41-1/4"	3/4"
OLF630	5-1/2"	29-1/4"	3/4"
OLF636	5-1/2"	35-1/4"	3/4"
OLF642	5-1/2"	41-1/4"	3/4"
OLF384	2-1/2"	78-3/4"	3/4"
OLF390	2-1/2"	84-3/4"	3/4"
OLF396	2-1/2"	90-3/4"	3/4"

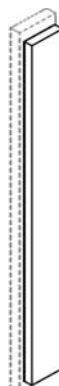

OLFXXX

Spec Sheets Decor Legs

Decor Legs

Item#	Width	Height	Thickness	Comments
TP3/WF34-1/2"	3"	34-1/2"	3"	Full leg. Comes with Wall Filler 3"x34-1/2"
LEG28 B3x3	3"	36-1/2"	3"	Full leg. Must trim 2" off top or bottom.
LEG75 B3x3	3"	36-1/2"	3"	Full leg. Must trim 2" off top or bottom.
LEG81	3"	34-1/2"	3"	Full Leg
LEG82	3"	34-1/2"	1-1/2"	1/2 Leg.
LEG83	3"	34-1/2"	1-1/2"	1/2 Leg
LEG-SMALL51	3"	4-1/2"	1-1/2"	1/2 Leg
LEG-SMALL52	3"	4-1/2"	1-1/2"	1/2 Leg
POLE28-B3	3"	36-1/2"	3"	Must trim 2" off top or bottom
POLE28-W330	3"	30"	2-1/4"	Trimmable 2" off top and bottom
POLE28-W336	3"	36"	2-1/4"	Trimmable 2" off top and bottom
POLE28-W342	3"	42"	2-1/4"	Trimmable 2" off top and bottom
POLE28-T384	3"	84"	2-1/4"	Trimmable to different length & depth
POLE28-T390	3"	90"	2-1/4"	Trimmable to different length & depth
POLE28-T396	3"	96"	2-1/4"	Trimmable to different length & depth
POLE75-B3	3"	36-1/2"	3"	Must trim 2" off top or bottom
POLE75-W330	3"	30"	2-1/4"	Trimmable 2" off top and bottom
POLE75-W336	3"	36"	2-1/4"	Trimmable 2" off top and bottom
POLE75-W342	3"	42"	2-1/4"	Trimmable 2" off top and bottom
POLE75-T384	3"	84"	2-1/4"	Trimmable to different length & depth
POLE75-T390	3"	90"	2-1/4"	Trimmable to different length & depth
POLE75-T396	3"	96"	2-1/4"	Trimmable to different length & depth



TP3/WF34-1/2"



LEG28 B3x3



LEG75 B3x3



LEG81



LEG82



LEG83



LEG-SMALL51



LEG-SMALL52



POLE28B



POLE28WF



POLE75B



POLE75W

Vanities With Drawers

Item#	Width	Height	Depth	Door	Drawer	Drawer Width	Bowl
S3021DL-34-1/2"	30"	34-1/2"	21"	1	2	11-1/2"	Single
S3021DR-34-1/2"	30"	34-1/2"	21"	1	2	11-1/2"	Single
S3621BDL-34-1/2"	36"	34-1/2"	21"	2	2	11-1/2"	Single
S3621BDR-34-1/2"	36"	34-1/2"	21"	2	2	11-1/2"	Single
S4821B12D-34-1/2"	48"	34-1/2"	21"	4	2	11-1/2"	Single
S6021B12D-34-1/2"	60"	34-1/2"	21"	4	2	11-1/2"	Single

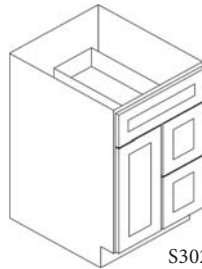

S3021DR

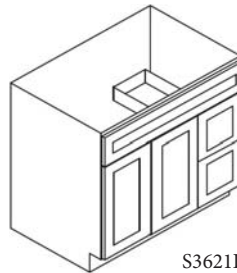

S3621DR

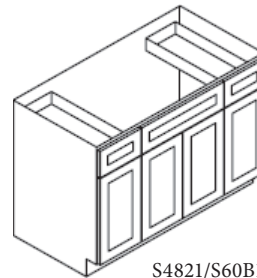

S4821/S60B12D

Vanities Without Drawers

Item#	Width	Height	Depth	Door	Drawer	Bowl
S2421B-30"H	24"	30"	21"	2	0	Single
S2421B-34-1/2"	24"	34-1/2"	21"	2	0	Single
S3021B-34-1/2"	30"	34-1/2"	21"	2	0	Single
S3621B-34-1/2"	36"	34-1/2"	21"	2	0	Single

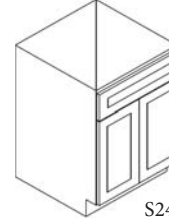

S24,S30,S36

Vanity Drawer Bases

Item#	Width	Height	Depth	Door	Drawer
SVB1221-34-1/2"	12"	34-1/2"	21"	0	3
SVB1521-34-1/2"	15"	34-1/2"	21"	0	3
SVB1821-34-1/2"	18"	34-1/2"	21"	0	3

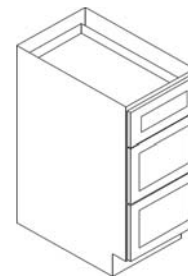

SVB

Desk Drawer (Makeup Sink)

Item#	Width	Height	Depth
SVDU3021-7"	30"	7"	20"

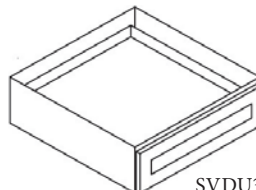

SVDU3021-7"



New Website Available January 2021

www.matrixcabinets.com

- Faster and more efficient
- 20/20 and Pro Kitchen upload capabilities
- Ability to store an unlimited number of drafts (quotes)
- Real time order tracking
- Checkout and pay online (credit card and check accepted)
- Mobile friendly

Easy Set Up for Current Dealers

- Go to www.matrixcabinets.com
- Click “Dealer Login”
- Click “Forgot Password”
- Enter email address that your account is registered with
 - If specific address is unknown contact Leasia@matrixcabinets.com
- Click “Reset Password”
- Link will be sent to your email address, follow link to reset password
- Start Shopping

Quick Notes

- New Orders should always start at the draft page
 - “Create New Draft”
 - This allows orders to be saved and copied for future use
- Quick Cart
 - Should only be used when needing a couple of items (maybe a piece of trim that was forgotten on a previous order)
- Refine By
 - Allows products to be sorted to better assist in searching
 - If Refine by doesn’t produce the wanted result, use the search feature on the top right of the page
- For all other questions, please contact your sales representative

Order Form (Silver 1)

Customer: _____ Date: _____

Ship To: _____ PO: _____

Delivery Residential Lift Gate Assembly

Please check box to select style:

K-Cherry Glaze (KC) K-Cinnamon Glaze (KM) K-Espresso (KE)

QTY		QTY		QTY		QTY	
	30" Wall		42" Wall		18" Bridge		Oven Cabinets
	W0930		W0942		W2418B		OC3384B
	W1230		W1242		W3018B		OC3390B
	W1530		W1542		W301824B		OC3396B
	W1830		W1842		W3318B		
	W2130		W2142		W331824B		Wall Pantries
	W2430B		W2442B		W3618B		WP1584 (KC, KM)
	W2730B		W2742B		W361824B		WP1590 (KC, KM)
	W3030B		W3042B				WP1596 (KC, KM)
	W3330B		W3342B		24" Bridge		WP1884
	W3630B		W3642B		W2424B		WP1890
					W3024B		WP1896
	36" Wall		12" Bridge		W302424B		WP2484B
	W0936		W3012B		W3324B		WP2490B
	W1236		W3612B		W3624B		WP2496B
	W1536		W361224B		W362424B		
	W1836						Décor Legs
	W2136		15" Bridge		Wall Corner Cabinets		TP3/WF34-1/2"
	W2436B		W3015B		WDC2430		LEG81 (KM)
	W2736B		W301524B		WDC2436		LEG82 (KM)
	W3036B		W3315B		WDC2442		LEG-SMALL51 (KM)
	W3336B		W331524B				LEG-SMALL52 (KC, KM)
	W3636B		W3615B				
			W361524B		Angle Wall		Valances
	Glass Doors (Mullion)				AW30 (with door)		VAS48
	W3030BMGD (2pcs)		Wall End Shelf		AW36 (with door)		VAD3612
	W3036BMGD (2pcs)		WES530		AW42 (with door)		VAD4212
	W3042BMGD (2pcs)		WES536				VAD4812
	WDC2430MGD		WES542		Wine Rack		
	WDC2436MGD				W3018WR		
	WDC2442MGD		Microwave Oven Wall				
	WDC2442MGD		MW03018PM-12"				

Order Form (Silver 2)

Customer: _____ Date: _____

Ship To: _____ PO: _____

Delivery Residential Lift Gate Assembly

Please check box to select style:

K-Cherry Glaze (KC) K-Cinnamon Glaze (KM) K-Espresso (KE)

QTY		QTY		QTY		QTY	
	Bases		Blind Bases		Fillers		Corbels & Appliques
	B09		BBLC39/42-36"W DL		WF3-3/4		DOA (KM)
	B12		BBLC39/42-36"W DR		WF336-3/4		CORBEL54
	B15		BBLC42/45-39"W DL		WF342-3/4		CORBEL55 (KM)
	B18		BBLC42/45-39"W DR		WF384-3/4		CORBEL56 (KM)
	B21		BBLC45/48-42"W DL		WF396-3/4		CORBEL57 (KC,KM)
	B24B		BBLC45/48-42"W DR		WF6-3/4		CORBEL58 (KM)
	B27B				WF642-3/4		CORBEL59
	B30B		Decorative Doors		WF696-3/4		CORBEL60S (KC,KM)
	B33B		EPW1230D		BF3-3/4		CORBEL60L (KC, KM)
	B36B		EPW1236D		BF6-3/4		
			EPW1242D		A30WF		Vanities
	Drawer Bases		EPB24D		A36WF		S3021DL-34-1/2"
	DB12(3)				A42WF		S3021DR-34-1/2"
	DB15(3)				A3BF		S3621DL-34-1/2"
	DB18(3)		Panels		A6BF (KC,KM)		S3621DR-34-1/2"
	DB21(3)		DWR33412				S4821B12D-34-1/2"
	DB24(3)		REP2484-3/4"		Trims/Moldings		S6021B12D-34-1/2"
	DB30(3)		REP2496-3/4"		TK8		S2421B-30"H
			REP2484(3)-3/4"		BM4-1/2-5/8-96		S2421B-34-1/2"
	Sink Bases		REP2496(3)-3/4"		SC1-3		S3021B-34-1/2"
	SB24B (KC, KM)		REP3096(3)-3/4"		SC4		S3621B-34-1/2"
	SB27B		FBP483614(1)(KC,KM)		SC5		SVB1221-34-1/2"
	SB30B		FBP369614(1)(KC,KM)		SC6		SVB1521-34-1/2"
	SB33B		FBP489614(1)		SC8		SVB1821-34-1/2"
	SB36B		BP48341214		LRM8		
	SB60B				TLRM8 (2-1/2")		Trash Can Pull Out
	BDCF36		Roll Outs Trays		CM96		TCR21-2
	BDCF36K-FL		15RT-DR		CM96-4		
			18RT-DR		CM96C-4		Sample Door (\$30)
	Base Corner Cabinets		24RT-DR				Sample Bag (\$120)
	LS3309		27RT-DR		Drawer Glides		Repair Kit (\$14)
	LS3612		30RT-DR		J20-09 (\$22)		Stain/Spray Paint (\$26)
	LS3612S (EZR3612)		33RT-DR		J20-15 (\$22)		
	AB24		36RT-DR		J20-18 (\$22)		
					J20-21 (\$22)		
					J20-24 (\$22)		

Order Form (Gold 1)

Customer: _____ Date: _____

Ship To: _____ PO: _____

Delivery Residential Lift Gate Assembly

Please check box to select style:

Ice White Shaker (AW) Pepper Shaker (AP)

QTY	30" Wall	QTY	12" Wall	QTY	Wall Corner Cabinets	QTY	Glass Doors (No Mullion)	QTY	Corbels & Appliques
	W0930		W3012B		WDC2430		W3012BGD (AW)		DOA
	W1230		W3312B (AW)		WDC2436		W1530GD		CORBEL56 (AW)
	W1530		W3612B		WDC2442		W1830GD		CORBEL57 (AW)
	W1830		W361224B		WDC273615		W2430BGD (AW)		CORBEL58 (AP)
	W2130		W1512 (AW)		WDC274215		W3030BGD		CORBEL59
	W2430B		W1812 (AW)		WSQ2430		W3630BGD		CORBEL60S (AW)
	W2730B		W2412 (AW)		WSQ2436		WDC2430GD		CORBEL75S (AW)
	W3030B		WDC2412 (AW)		WSQ2442		W1536GD		CORBEL75M (AW)
	W3330B						W1836GD		CORBEL75L (AW)
	W3630B		15" Wall		Wall End Shelf		W2436BGD (AW)		
			W2415B		WES530		W3036BGD		Décor Legs
	36" Wall		W3015B		WES536		W3636BGD		TP3/WF34-1/2"
	W0936		W301524B		WES542		WDC2436GD		LEG75 B3x3 (AW)
	W1236		W3315B				WDC273615GD		LEG81
	W1536		W331524B		Wall Cubes		W1542GD		LEG82
	W1836		W3615B		WC630		W1842GD		LEG83 (AW)
	W2136		W361524B		WC636		W2442BGD (AW)		POLE75-B3 (AW)
	W2436B				WC642		W3042BGD		POLE75-W330 (AW)
	W2736B		18" Wall				W3642BGD		POLE75-W336 (AW)
	W3036B		W2418B		Wine Rack		WDC2442GD		POLE75-W342 (AW)
	W3336B		W3018B		W3018WR		WDC274215GD		POLE75-T384 (AW)
	W3636B		W301824B						POLE75-T390 (AW)
			W3318B		Microwave Oven Wall		Bridge Glass Door		POLE75-T396 (AW)
	42" Wall		W331824B		MWO3018PM-12		W3012BGD (AW)		
	W0942		W3618B						Sample Door (\$30)
	W1242		W361824B		Angle Wall		Decorative Doors		Sample Bag (\$85)
	W1542				AW30		EPW1230D		Repair Kit (\$14)
	W1842		24" Wall		AW36		EPW1236D		Stain/Spray Paint (\$26)
	W2142		W2424B		AW42		EPW1242D		
	W2442B		W3024B				EPB24D		
	W2742B		W302424B		Valances		EPWP2484(2)		Drawer Glides
	W3042B		W3324B		VAS48		EPWP2490(2)		S50-09 (\$22)
	W3342B		W332424B		VAD3612		EPWP2496(2)		S50-15 (\$22)
	W3642B		W3624B		VAD4212				S50-18 (\$22)
	Wall Cabinet		W362424B		VAD4812		Range Hood		S50-21 (\$22)
	With 2 Drawers				VAL48S		AWH36		S50-24 (\$22)
	W2D1848 (AW)				VAL54S		CWH36 (AW)		
	W2D1854 (AW)								
	W2D1860 (AW)								

Order Form (Gold 2)

Customer: _____ Date: _____

Ship To: _____ PO: _____

Please check box to select style:

Ice White Shaker (AW) Pepper Shaker (AP)

QTY		QTY		QTY		QTY		QTY	
	Bases		Base Corner Cabinets		Oven Cabinets		Fillers		Trims/Moldings
	B09		LS3309		OC3384B		WF3-3/4		TK8
	B12		LS3612		OC3390B		WF336-3/4		BM4-1/2"-5/8"
	B15		LS3612S (EZR3612)		OC3396B		WF342-3/4		SC1-3 (SM)
	B18		AB24		OM3384B (AW)		WF384-3/4		SC4 (ICM)
	B21				OM3390B (AW)		WF396-3/4		SC5 (OCM)
	B24B		Blind Bases		OM3396B (AW)		WF6-3/4		SC6 (SM) (AW)
	B27B		BBLC39/42-36"W DL				WF642-3/4		SC8 (BM) (AW)
	B30B		BBLC39/42-36"W DR		Roll Out Trays		WF696-3/4		LRM8
	B33B		BBLC42/45-39"W DL		15RT-DR		BF3-3/4		TLRM8
	B36B		BBLC42/45-39"W DR		18RT-DR		BF6-3/4		CM96
			BBLC45/48-42"W DL		24RT-DR		A30WF		CM96-4
	Drawer Bases		BBLC45/48-42"W DR		27RT-DR		A36WF		CM96C-4 (AW)
	DB12(3)				30RT-DR		A42WF		CM96E-4
	DB15(3)				33RT-DR		A3BF		CM96H-4
	DB18(3)		Base Spice Pull Out		36RT-DR		A6BF		CM96K-4
	DB21(3)		BFP09				CLB334-1/2		
	DB24(3)				Trash Can Pull Out		CLW330 (AW)		Vanities
	DB30(3)		Microwave Base		TCR21-2		CLW336 (AW)		S3021DL-34-1/2"
	DB36(3)		B30MW/(30"W)				CLW342 (AW)		S3021DR-34-1/2"
					Panels		CLW396 (AW)		S3621BDL-34-1/2"
	Sink Bases		Base Transitional		DWR33412		OLF330 (AW)		S3621BDR-34-1/2"
	SB24B		BTC12L		FBP483614(1)		OLF336 (AW)		S4821B12D-34-1/2"
	SB27B		BTC12R		FBP369614(1)		OLF342 (AW)		S6021B12D-34-1/2"
	SB30B				FBP489614(1)		OLF630 (AW)		S2421B-34-1/2"
	SB33B		Tall Cabinets		BP48341214		OLF636 (AW)		S3021B-34-1/2"
	SB36B		WP1584		REP2484-3/4"		OLF642 (AW)		S3621B-34-1/2"
	SB42B (AW)		WP1590		REP2496-3/4"		OLF384 (AW)		SVB1221-34-1/2"
	FSB30B (AW)		WP1596		REP2484(3)-3/4"		OLF390 (AW)		SVB1521-34-1/2"
	FSB33B (AW)		WP1884		REP2496(3)-3/4"		OLF396 (AW)		SVB1821-34-1/2"
	FSB36B		WP1890		REP3096(3)-3/4"				SVDU3021-7"
	BDCF36		WP1896						
	BDCF36K-FL		WP2484B						
			WP2490B						
			WP2496B						

Order Form (Platinum 1)

Customer: _____ Date: _____

Ship To: _____ PO: _____

Delivery Residential Lift Gate Assembly

Please check box to select style:

Lait Grey (AB) Signature Pearl (SL) Gramercy White (GW) Greystone Shaker (AG)
 Xterra Blue Shaker (AX) Uptown White (TW) Townsquare Grey (TS)

QTY	30" Wall	QTY	15" Wall	QTY	Wall Corner Cabinets	QTY	Glass Doors (Mullion)	QTY	
	W0930		W2415B		WDC2430		(GW, MR, SL, TS, TW)		
	W1230		W3015B		WDC2436		W1530MGD		
	W1530		W301524B		WDC2442		W1830MGD		
	W1830		W3315B		WDC273615		W2430BMGD (GW,SL,TS,TW)		
	W2130		W331524B		WDC274215		W3030BMGD		Corbels & Appliques (Not available in AX)
	W2430B		W3615B		WSQ2430		W3630BMGD (GW, SL, TS)		DOA (GW,SL,TW)
	W2730B		W361524B		WSQ2436		WDC2430MGD		CORBEL56
	W3030B				WSQ2442		W1536MGD		CORBEL57
	W3330B		18" Wall				W1836MGD		CORBEL59 (Not in SL)
	W3630B		W2418B		Wall Cabinet		W2436BMGD (GW,SL,TS,TW)		CORBEL60S
			W3018B		With 2 Drawers		W3036BMGD		CORBEL60L (SL Only)
	36" Wall		W301824B		W2D1848		W3636BMGD (GW,SL,TS)		CORBEL75S (Not available in SL)
	W0936		W3318B		W2D1854		WDC2436MGD		CORBEL75M (Not available in SL)
	W1236		W331824B		W2D1860		WDC273615MGD		CORBEL75L (Not available in SL)
	W1536		W3618B				W1542MGD		
	W1836		W361824B		Glass Doors (No Mullion)		W1842MGD		Décor Legs
	W2136				(AB, AG, AX, TS, TW)		W2442BMGD (GW,SL,TS,TW)		TP3/WF34-1/2"1 (GW,SL,TW)
	W2436B		24" Wall		W1530GD		W3042BMGD		LEG75 B3x32 (AB,AG,AX,GW,TS,TW)
	W2736B		W2424B		W1830GD		W3642BMGD (GW,SL,TS)		LEG81 (GW,SL,TW)
	W3036B		W3024B		W2430BGD (AG Only)		WDC2442MGD		LEG83 (GW,SL,TW)
	W3336B		W302424B		W3030BGD		WDC274215MGD		POLE75-B3 (AB,AG,GW,TS,TW)
	W3636B		W3324B		W3630BGD				POLE75-W330 (AB,AG,GW,TS,TW)
			W332424B		WDC2430GD		Decorative Doors		POLE75-W336 (AB,AG,GW,TS,TW)
	42" Wall		W3624B		W1536GD		EPW1230D		POLE75-W342 (AB,AG,GW,TS,TW)
	W0942		W362424B		W1836GD		EPW1236D		POLE75-T384 (AB,AG,GW,TS,TW)
	W1242				W2436BGD (AG Only)		EPW1242D		POLE75-T390 (AB,AG,GW,TS,TW)
	W1542		Angle Wall		W3036BGD		EPB24D		POLE75-T396 (AB,AG,GW,TS,TW)
	W1842		AW30		W3636BGD		EPWP2484(2)		
	W2142		AW36		WDC2436GD		EPWP2490(2)		Décor Legs (SL Only)
	W2442B		AW42		WDC273615GD		EPWP2496(2)		LEG28 B3x3
	W2742B				W1542GD				POLE28-B3
	W3042B		Wine Rack		W1842GD		Valances		POLE28-W330
	W3342B		W3018WR		W2442BGD (AG Only)		VAS48 (SL Only)		POLE28-W336
	W3642B				W3042BGD		VAD3612 (GW,SL)		POLE28-W342
			Wall Cubes		W3642BGD		VAD4212 (GW,SL)		POLE28-T384
	12" Wall		WC630		WDC2442GD		VAD4812 (GW,SL)		POLE28-T390
	W3012B		WC636		WDC274215GD		VAL48B (AX,GW,SL,TW)		POLE28-T396
	W3312B (Not in MR)		WC642				VAL54B (AX,GW,SL,TW)		
	W3612B				Bridge Glass Door		VAL48S (AB,AG,AX,TS)		Range Hoods
	W361224B		Wall End Shelf		W3012BGD (AB,AG,AX,TS,TW)		VAL54S (AB,AG,AX,TS)		AWH36
	W1512 (AG, TW)		WES530						CWH36
	W1812 (AG,TW)		WES536		Microwave Oven Wall				
	W2415 (AG,TW)		WES542		MWO3018PM-12				
	WDC2412 (AG,TW)								

Order Form (Platinum 2)

Customer: _____ Date: _____

Ship To: _____ PO: _____

Please check box to select style:

- Lait Grey (AB)
 Signature Pearl (SL)
 Gramercy White (GW)
 Greystone Shaker (AG)
 Xterra Blue Shaker (AX)
 Uptown White (TW)
 Townsquare Grey (TS)

QTY		QTY		QTY		QTY		QTY	
	Base Cabinets		Base Corner Cabinets		Oven Cabinets		Fillers		Trims/Moldings
	B09		LS3309		OC3384B		WF3-3/4		TK8
	B12		LS3612		OC3390B		WF336-3/4		BM4-1/2"-5/8"
	B15		LS3612S (EZR3612)		OC3396B		WF342-3/4		SC1-3 (SM)
	B18		AB24		OM3384B		WF384-3/4		SC4 (ICM)
	B21				OM3390B		WF396-3/4		SC5 (OCM)
	B24B		Blind Bases		OM3396B		WF6-3/4		SC6 (SM)
	B27B		BBLC39/42-36"W DL				WF642-3/4		SC8 (BM)
	B30B		BBLC39/42-36"W DR		Roll Out Trays		WF696-3/4		LRM8
	B33B		BBLC42/45-39"W DL		15RT-DR		BF3-3/4		TLRM8
	B36B		BBLC42/45-39"W DR		18RT-DR		BF6-3/4		CM96
			BBLC45/48-42"W DL		24RT-DR		A30WF (GW,SL,TW)		CM96-4 (AB,AX,GW,SL,TW)
	Drawer Bases		BBLC45/48-42"W DR		27RT-DR		A36WF (GW,SL,TW)		CM96B-4 (SL)
	DB12(3)				30RT-DR		A42WF (GW,SL,TW)		CM96C-4 (GW,SL,TW)
	DB15(3)		Base Spice Pull Out		33RT-DR		A3BF (GW,SL,TW)		CM96E-4 (GW,TW)
	DB18(3)		BFP09		36RT-DR		A6BF (GW,SL,TW)		CM96H-4 (AB,AG,AX,GW,TS,TW)
	DB21(3)						CLB334-1/2		CM96K-4 (AB,AG,AX,GW,TS,TW)
	DB24(3)		Microwave Base		Trash Can Pull Out		CLW330		
	DB30(3)		B30MW/(30"W)		TCR21-2		CLW336		Trimmable Pilaster (SL Only)
	DB36(3)						CLW342		CFC96
			Base Transitional		Panels		CLW396		
	Sink Bases		BTC12L		DWR33412		OLF330		Vanities
	SB24B		BTC12R		FBP483614(1)		OLF336		S3021DL-34-1/2"
	SB27B				FBP369614(1)		OLF342		S3021DR-34-1/2"
	SB30B		Tall Cabinets		FBP489614(1)		OLF630		S3621BDL-34-1/2"
	SB33B		WP1584		BP48341214		OLF636		S3621BDR-34-1/2"
	SB36B		WP1590		REP2484-3/4"		OLF642		S4821B12D-34-1/2"
	SB42B		WP1596		REP2496-3/4"		OLF384		S6021B12D-34-1/2" (Not in AX,GW,TW)
	FSB30B		WP1884		REP2484(3)-3/4"		OLF390		S2421B-34-1/2"
	FSB33B		WP1890		REP2496(3)-3/4"		OLF396		S3021B-34-1/2"
	FSB36B		WP1896		REP3096(3)-3/4"				S3621B-34-1/2"
	BDCF36		WP2484B				Drawer Glides		SVB1221-34-1/2"
	BDCF36K-FL		WP2490B		Sample Door (\$30)		S50-09 (\$22)		SVB1521-34-1/2"
			WP2496B		Sample Bag (\$120)		S50-15 (\$22)		SVB1821-34-1/2" (Not in AX)
					Repair Kit (\$14)		S50-18 (\$22)		SVDU3021-7"
			Lattice Doors (GW,SLTW)		Stain/Spray Paint (\$26)		S50-21 (\$22)		
			SB30B-ND-SP				S50-24 (\$22)		
			SB33B-ND-SP						
			SB36B-ND-SP						

Order Form (Titanium 1)

Customer: _____ Date: _____

Ship To: _____ PO: _____

Delivery Residential Lift Gate Assembly

Please check box to select style:

Nova Light Grey Shaker (AN) Midtown Grey (TG) Townplace Crema (TQ)

QTY		QTY		QTY		QTY		QTY	
	30" Wall		15" Wall		Wall Corner Cabinets		Glass Doors (No Mullion)		Corbels & Appliques
	W0930		W2415B		WDC2430		W1530GD		CORBEL56 (TQ)
	W1230		W3015B		WDC2436		W1830GD		CORBEL57 (TQ)
	W1530		W301524B		WDC2442		W2430BGD (AN)		CORBEL59
	W1830		W3315B		WDC273615		W3030BGD		CORBEL60S
	W2130		W331524B		WDC274215		W3630BGD		CORBEL75S
	W2430B		W3615B		WSQ2430		WDC2430GD		CORBEL75M
	W2730B		W361524B		WSQ2436		W1536GD		CORBEL75L
	W3030B				WSQ2442		W1836GD		
	W3330B		18" Wall				W2436BGD (AN)		Valances
	W3630B		W2418B		Wall Cabinet		W3036BGD		VAL48B (TG, TQ)
			W3018B		With 2 Drawers		W3636BGD		VAL54B (TG, TQ)
	36" Wall		W301824B		W2D1848		WDC2436GD		VAL48S (AN)
	W0936		W3318B		W2D1854		WDC273615GD		VAL54S (AN)
	W1236		W331824B		W2D1860		W1542GD		VAD3612 (TQ)
	W1536		W3618B				W1842GD		VAD4212 (TQ)
	W1836		W361824B		Wall Cubes		W2442BGD (AN)		VAD4812 (TQ)
	W2136				WC630		W3042BGD		
	W2436B		24" Wall		WC636		W3642BGD		Décor Legs
	W2736B		W2424B		WC642		WDC2442GD		TP3/WF34-1/2" (TQ)
	W3036B		W3024B				WDC274215GD		LEG28 B3x3 (TQ)
	W3336B		W302424B		Glass Doors (Mullion)				LEG75 B3x3
	W3636B		W3324B		W1530MGD		Bridge Glass Door		LEG81 (TQ)
			W332424B		W1830MGD		W3012BGD (AN, TQ)		POLE28-B3 (TQ)
	42" Wall		W3624B		W2430BMGD (TG, TQ)				POLE28-W330 (TQ)
	W0942		W362424B		W3030BMGD		Decorative Doors		POLE28-W336 (TQ)
	W1242				W3630BMGD (AN, TG)		EPW1230D		POLE28-W342 (TG, TQ)
	W1542		Angle Wall		WDC2430MGD		EPW1236D		POLE75-B3
	W1842		AW30		W1536MGD		EPW1242D		POLE75-W330
	W2142		AW36		W1836MGD		EPB24D		POLE75-W336
	W2442B		AW42		W2436BMGD (TG, TQ)		EPWP2484(2)		POLE75-W342
	W2742B				W3036BMGD		EPWP2490(2)		POLE75-T384
	W3042B		Wine Rack		W3636BMGD (AN, TQ)		EPWP2496(2)		POLE75-T390
	W3342B		W3018WR		WDC2436MGD				POLE75-T396
	W3642B				WDC273615MGD				
			Microwave Oven Wall		W1542MGD		Range Hoods		Drawer Glides
	12" Wall		MWO3018PM-12		W1842MGD		AWH36		S50-09 (\$22)
	W3012B				W2442BMGD (TG, TQ)		CWH36		S50-15 (\$22)
	W3312B		Wall End Shelf		W3042BMGD				S50-18 (\$22)
	W3612B		WES530		W3642BMGD (AN, TQ)				S50-21 (\$22)
	W361224B		WES536		WDC2442MGD				S50-24 (\$22)
			WES542		WDC274215MGD				

Order Form (Titanium 2)

Customer: _____ Date: _____

Ship To: _____ PO: _____

Please check box to select style:

Nova Light Grey Shaker (AN) Midtown Grey (TG) Townplace Crema (TQ)

QTY		QTY		QTY		QTY		QTY	
	Base Cabinets		Base Corner Cabinets		Oven Cabinets		Fillers		Trims/Moldings
	B09		LS3309		OC3384B		WF3-3/4		TK8
	B12		LS3612		OC3390B		WF336-3/4		BM4-1/2"-5/8"
	B15		LS3612S (EZR3612)		OC3396B		WF342-3/4		SC1-3 (SM)
	B18		AB24		OM3384B		WF384-3/4		SC4 (ICM)
	B21				OM3390B		WF396-3/4		SC5 (OCM)
	B24B		Blind Bases		OM3396B		WF6-3/4		SC6 (SM) (AW)
	B27B		BBLC39/42-36"W DL				WF642-3/4		SC8 (BM) (AW)
	B30B		BBLC39/42-36"W DR		Roll Out Trays		WF696-3/4		LRM8
	B33B		BBLC42/45-39"W DL		15RT-DR		BF3-3/4		TLRM8
	B36B		BBLC42/45-39"W DR		18RT-DR		BF6-3/4		CM96
			BBLC45/48-42"W DL		24RT-DR		A30WF (TQ)		CM96-4 (TQ)
	Drawer Bases		BBLC45/48-42"W DR		27RT-DR		A36WF (TQ)		CM96H-4
	DB12(3)				30RT-DR		A42WF (TQ)		CM96K-4 (AN,TG)
	DB15(3)		Base Spice Pull Out		33RT-DR		A3BF (TQ)		
	DB18(3)		BFP09		36RT-DR		A6BF (TQ)		Vanities
	DB21(3)						CLB334-1/2		S3021DL-34-1/2"
	DB24(3)		Microwave Base		Base Transitional		CLW330		S3021DR-34-1/2"
	DB30(3)		B30MW/(30"W)		BTC12L		CLW336		S3621BDL-34-1/2"
	DB36(3)				BTC12R		CLW342		S3621BDR-34-1/2"
			Trash Can Pull Out				CLW396		S4821B12D-34-1/2"
	Sink Bases		TCR21-2		Panels		OLF330		S2421B-34-1/2"
	SB24B				DWR33412		OLF336		S3021B-34-1/2"
	SB27B		Tall Cabinets		FBP483614(1)		OLF342		S3621B-34-1/2"
	SB30B		WP1584		FBP369614(1)		OLF630		SVB1221-34-1/2"
	SB33B		WP1590		FBP489614(1)		OLF636		SVB1521-34-1/2"
	SB36B		WP1596		BP48341214		OLF642		SVB1821-34-1/2" (TQ)
	SB42B		WP1884		REP2484-3/4"		OLF384		SVDU3021-7"
	FSB30B		WP1890		REP2496-3/4"		OLF390		
	FSB33B		WP1896		REP2484(3)-3/4"		OLF396		Sample Door (\$30)
	FSB36B		WP2484B		REP2496(3)-3/4"				Sample Bag (\$120)
	BDCF36		WP2490B		REP3096(3)-3/4"				Repair Kit (\$14)
	BDCF36K-FL		WP2496B						Stain/Spray Paint (\$26)



WARRANTY FORM

Warranty Email: warranty@matrixcabinets.com Fax (912) 366-0122

Please fill out this form in full. All fields are required and will not be processed unless this form is filled out in its entirety. Fax form to (912) 366-0122 or email to warranty@matrixcabinets.com.

RETURN REPLACEMENT MISSING ITEM

Company Name _____ Date _____

Phone Number _____ Email Address _____

Matrix Cabinets Invoice # (required) _____ Date of Shipment _____

If available, please provide PO# on cabinet box (K/D only) _____

Item(s)/Part(s) for return/replacement. Please specify SKU(s) and part (door, drawer header, glides, etc)

REASON FOR RETURN *(required)*

Wrong item or quantity ordered

Other (Please Specify) _____

REASON FOR REPLACEMENT *(required)*

Ship replacement to _____

Return only

Please note that returns are only accepted K/D, in good condition, and in original packaging. Assembled cabinets are not accepted for return. Returns are accepted up to 60 days after shipment date. All returns are subject to inspection and a 25% restocking fee. Returns are accepted for credit only to dealer account. Dealer is responsible for return freight. Credit must be used within 6 months of issue.

Replacement only

Please note that items damaged due to shipping can only be claimed up to 7 days after shipment date. This includes and is not limited to shipping damages, dents or scratches. Replacements will not be issued for any damaged items that are altered or installed (i.e. handles) unless it is an issue under factory warranty. Replacement items ship via ground carrier. Expedited replacement items cannot be accommodated. All damaged items must be submitted at one time. Otherwise, additional charges may occur. Some replacement parts are subject to availability, and may differ from those originally supplied. Please see warranty page and catalogue for more information.

Please send photographs of item(s) claimed for replacement to warranty@matrixcabinets.com Photographs must provide evidence of reason for replacement. If photographs are not received within 30 days of claim, Matrix Cabinets reserves the right to charge dealer for replacement items unless arrangements are made to return claimed items.

I, the undersigned, hereby declare the above information to be true and correct to the best of my knowledge.

Form Prepared By (Print Name) _____ Title _____

Signature _____

